



Table of Contents

Package Contents.....	2
ARCHOS Indoor Module.....	3
ARCHOS Outdoor Module.....	5
ARCHOS Soil Module.....	6
Getting Stared.....	7
ARCHOS Weather Station- First Time Setup.....	8
ARCHOS Weather Station- Interface.....	10
ARCHOS Weather Station- Managing stations.....	11
ARCHOS Weather Station- Managing modules.....	15
Troubleshooting.....	16

For more information, please consult the FAQs of your product on www.archos.com. Make sure to read them before considering any product return. Changes can occur in the procedures due to application updates. Consult the declaration of conformity on http://www.archos.com/products/declaration_conformity.html

Package Contents



ARCHOS Indoor Module



ARCHOS Outdoor Module



ARCHOS Soil Module



2 x AA batteries



2x CR2032 batteries



AC Adapter



QSG Booklet



Warranty,
Legal & Safety Booklet



ARCHOS Indoor Module

Description of the Indoor Module

1. Reset button
2. Pairing indicator & Air quality LED
3. Power Connector



ACTION	LED STATUS
Module in pairing mode and waiting to be connected to device	LED blinks Blue
Mobile connected to module successfully	Blue LED always on

LED state indicators every time you want to reconnect your indoor module or during use.

ACTION	LED STATUS
Module in pairing mode and attempting to connect	Blue LED Flash almost immediately after power on
Module attempting to connect or lost connexion	LED blinks RED
Module connect successfully	Green LED on for 10s

ARCHOS Indoor Module

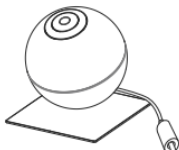

LED state indicator

Pass your hand over the LED and check the CO2 level according to the LED color to know your home air quality.

COLOR	AIR QUALITY
Green	Good Quality
Yellow	Quality could be improved
Red	Room should be ventilated



EN

ARCHOS Outdoor Module

Description of the Outdoor Module

1. Pairing indicator

The pairing is done by inserting the batteries. If no success, use the reset button to activate the pairing mode.

2. Base

3. Reset button

4. Battery holder

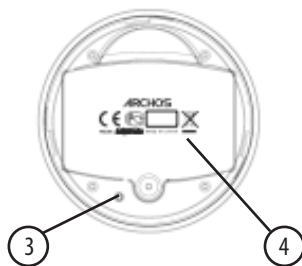
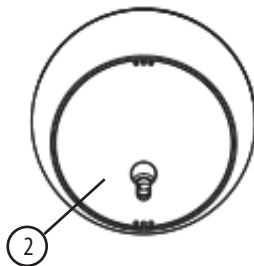
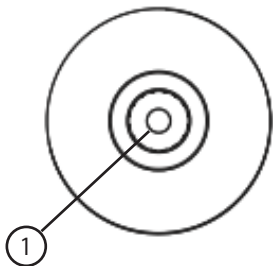

5



ARCHOS Soil Module

Description of the Soil Module

1. Reset button
2. Temperature & Humidity captor
3. Batteries compartment

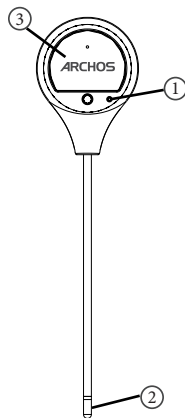



Getting Started

1. Connect your power cable into the Indoor Module power connector.



Your main device has to be permanently connected to the power supply

2. Download the ARCHOS Weather Station Application from Google Play Store or Apple Store and follow the configuration steps.

3. Put the Outdoor Module into service.

1. Unscrew the Outdoor module
2. Unscrew the Batteries compartment
3. Place two AA batteries
4. Screw back up compartment and close the Module

4. Put the Soil Sensor into service

1. Unscrew the Batteries compartment
2. Place two CR2032 batteries
3. Screw back up

1.

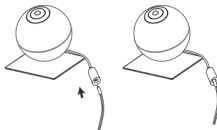

2.

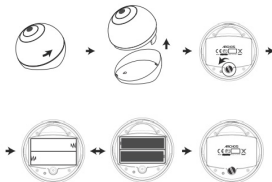

3.



ARCHOS WEATHER STATION- First Time Setup

The first time you launch the app, you will need to connect your weather station.

1. Download the ARCHOS Weather Station App from Google Play or Apple Store
2. Switch on the WiFi on your smartphone or tablet.
3. Launch the ARCHOS Weather Stationapp
4. Look for Archos weather stations by clicking on Connect your **Weather Station** and then select yours.
A new Weather Station must be powered ON to be recognized by the application and once selected, the LED must blink in blue. If it is not the case after a few minutes, perform a long press on the button below the station until the light blinks in blue.
5. Select your Wifi network and send the password to the weather station so that it can connect to internet.
6. Wait for your weather station to connect.
7. Register your weather station and set up your information: location, name



ARCHOS WEATHER STATION- First Time Setup

When your Weather Station is connected, add new sensors.

To pair the Outdoor Module

1. Make sure the two AA batteries are well placed in their support.
2. As soon as the batteries are in the module, it is in pairing mode.
3. Click on “add a new sensor” on your application.
4. Pairing success, if not try again the process and press the reset button.

To pair the Soil Module

1. Make sure the two CR2032 batteries are well placed in their support.
2. As soon as the batteries are in the module, it is in pairing mode.
3. Click on “**add a new sensor**” on your application .
4. Pairing success, if not try again the process and press the reset button.

ARCHOS WEATHER STATION - Interface

1. Weather Forecast for the next 6 days

2. Indoor sensors

- A. Temperature
- B. Humidity
- C. Atmospheric pressure
- D. CO2 level
- E. Noise level

3. Outdoor sensors

- A. Temperature
- B. Humidity

4. Soil sensors

- A. Temperature
- B. Humidity

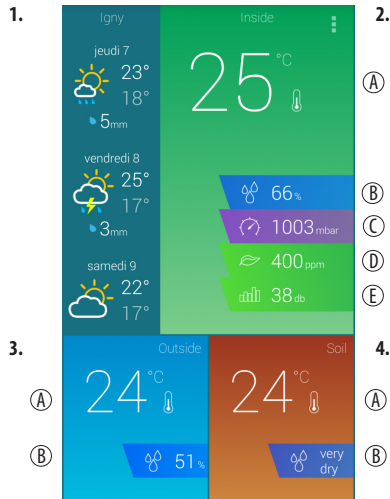



ARCHOS WEATHER STATION- Managing stations

When you are connected on your Archos Weather Station Application, check your modules' sensors data at any time.

1. Select the module sensor you're interested in and tap its icon.
2. Select your scale (1h, 2h, 6h, 12h, 1day, 2 days, 1 week).
3. Follow the evolution over time and compare against previous days/months/years through all the graphics provided by the application. Each sensor has its dedicated graph.

①



②

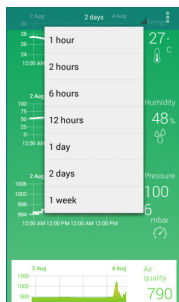

③

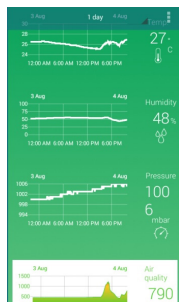

ARCHOS WEATHER STATION - Managing stations

You can add or remove Weather Stations at any time.

To add a Weather Station

1. Launch the Archos Weather Station app.
2. Tap (icon avec les 3 points) and select **Station Manager**.
3. Select Find stations.
4. You are redirected to the ARCHOS Weather Station home page.
5. Select Connect your Weather Station
6. Select the station you want to add.
7. Tap (icon 3 points) and switch between your stations by selecting the one you want.

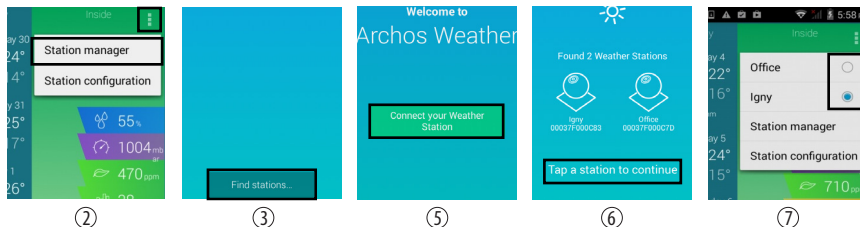



ARCHOS WEATHER STATION- Managing stations

To remove a Weather Station from the App

1. Launch the Archos Weather Station app.
2. Select Station Manager on parameter menu.
3. Select a station with a long press on its name.
4. Select Unregister.

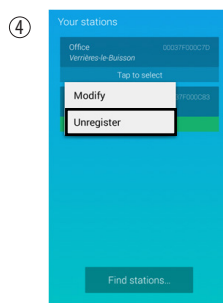
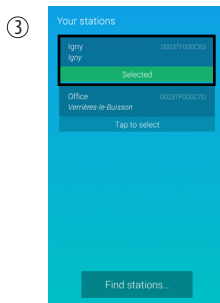
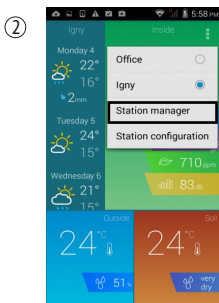

ARCHOS WEATHER STATION - Managing stations

To connect your Weather Station to another Wifi network

1. Launch the ARCHOS Weather Station app.
2. Pass your hand over the Indoor Module to see the green light indicator of air quality.
3. Hold your hand over the Indoor Module for at least 15 seconds.
4. The Indoor Module will blink blue and the station will turn in Access Point mode.
5. Tap (icon), select Station Manager and then Find stations.
6. Select your Wifi network and send the password to the Weather Station so that it can connect to internet.
7. While your Weather Station is connecting, the Indoor Module blinks red.
8. No need to register your Weather Station again.

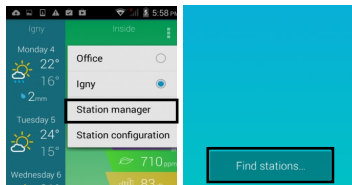

⑤

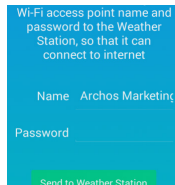

⑥

TIPS:

If you trigger this mode by accident, you can wait without doing any action on your ARCHOS Weather Station and after few minutes, it will automatically reconnect



ARCHOS WEATHER STATION- Managing modules

To add/remove a ARCHOS Weather Station sensor

1. Launch the ARCHOS Weather app
2. Make sure the sensors are in pairing mode
3. Tap (icon) and select Station Configuration (figure1)
4. Select Add or Remove a peripheral (figure2)

To add a new sensor

1. Select Add a new sensor (figure3)
2. Success, if not, check if the batteries are inserted and try again

To remove a sensor

1. Press the icon of the sensor you want to remove (figure4)
2. Click on OK to remove your sensor (figure5)

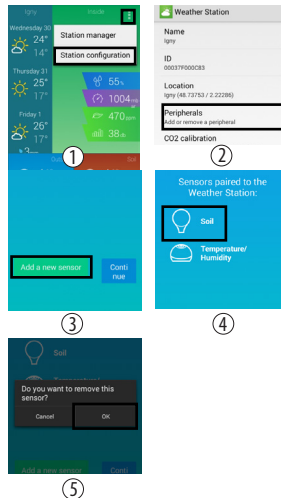

Troubleshooting

Why can't I connect to my Weather Station with my mobile device ?

Check if your mobile device and your Weather Station are both connected to the same WiFi.
Check if your device is paired to your Weather Station

Why aren't my sensors responding ? No data or no updated data. Are they correctly paired to your Archos Weather Station ?

You can check this information in 'Station Configuration' < 'Peripherals' Check if Wifi is ON in your device.
Check if the batteries are not empty for the Outdoor module and soil sensor. In that case you need to change them.
Check if your sensors are enough close to your Indoor Module.

How can I restore my Weather Station to its default settings ?

Use the reset button under your ARCHOS Weather Station.
Go to your ARCHOS Weather application settings: 'Station manager' < 'Select a station' < 'Unregister



Inhaltsverzeichnis

DE

Verpackungsinhalt.....	18
ARCHOS Innenmodul.....	19
ARCHOS Außenmodul.....	21
ARCHOS Bodenmodul.....	22
Erste Schritte.....	23
Ersteinrichtung der ARCHOS Weather Station.....	24
Benutzeroberfläche der ARCHOS Weather Station.....	26
ARCHOS Weather Station - Stationsverwaltung.....	27
ARCHOS Weather Station - Modulverwaltung.....	31
Fehlerbehebung.....	32

Weitere Informationen finden Sie in den FAQs für Ihr Produkt auf www.archos.com. Vor einer Rückgabe des Produkts, diese unbedingt durchlesen. Aufgrund von Anwendungsaktualisierungen können sich Abläufe ändern. Konsultieren Sie die Konformitätserklärung auf http://www.archos.com/products/declaration_conformity.html



DE

Verpackungsinhalt



ARCHOS Innenmodul



ARCHOS Außenmodul



ARCHOS Bodenmodul



2 x AA-Batterien



2 x CR2032-Batterien



Stromadapter



QRSG-Booklet



Booklet für
Garantie-, Rechts- und Si-
cherheitshinweise





ARCHOS Innenmodul

DE

Beschreibung des Innenmoduls

1. Reset-Taste
2. LED für Paarungsanzeige & Luftqualität
3. Stromanschluss

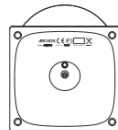

VORGANG	LED-STATUS
Modul in Paarungsmodus und wartet auf Verbindung mit Gerät	LED blinkt blau
Mobilgerät erfolgreich mit Modul verbunden	Blaue LED leuchtet dauerhaft

LED-Statusanzeigen bei Neuverbindung Ihres Innenmoduls oder während des Gebrauchs.

VORGANG	LED-STATUS
Modul in Paarungsmodus und Verbindungsversuch	Blaue LED blinkt kurz nach dem Einschalten
Modul versucht die verlorene Verbindung wiederherzustellen	LED blinkt ROT
Modul erfolgreich verbunden	Grüne LED leuchtet 10 s auf

19



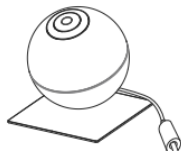

LED-Statusanzeige

Fahren Sie mit Ihrer Hand über die LED und überprüfen Sie den CO₂-Gehalt anhand der LED-Farbe, um so die Luftqualität Ihres Eigenheims zu bestimmen.

FARBE	LUFTQUALITÄT
Grün	Gute Qualität
Gelb	Qualität könnte besser sein
Rot	Raum sollte gelüftet werden



ARCHOS Außenmodul

DE

Beschreibung des Außenmoduls

1. Paarungsanzeige

Die Paarung erfolgt durch das Einlegen der Batterien. Ist die Paarung nicht erfolgreich, den Paarungsmodus mit der Reset-Taste aktivieren.

2. Basis

3. Reset-Taste

4. Batteriefassung

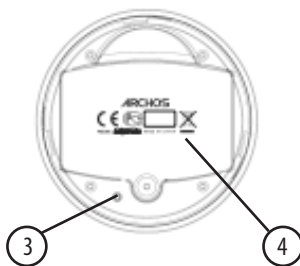
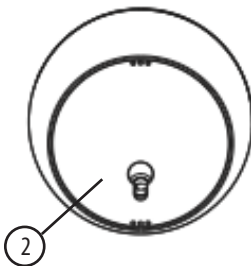
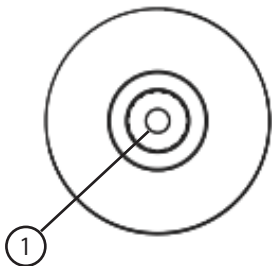



DE

ARCHOS Bodenmodul

Beschreibung des Bodenmoduls

1. Reset-Taste
2. Temperatur- & Feuchtigkeitsmesser
3. Batteriefach

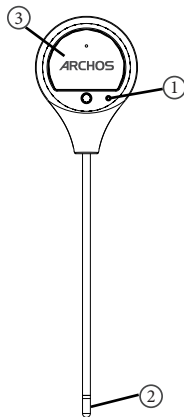



Erste Schritte

DE

1. Verbinden Sie das Netzkabel mit dem Stromanschluss des Innenmoduls.

 *Ihr Hauptgerät muss immer an die Stromversorgung angeschlossen sein*

2. Laden Sie die ARCHOS Weather Station Application vom Google Play Store oder Apple Store herunter und folgen Sie den Konfigurationsschritten.

3. Nehmen Sie das Außenmodul in Betrieb.

1. Das Außenmodul aufschrauben
2. Das Batteriefach aufschrauben
3. Legen Sie zwei AA-Batterien ein
4. Das Fach wieder anschrauben und das Modul schließen

4. Das Erdmodul in Betrieb nehmen

1. Das Batteriefach aufschrauben
2. Zwei CR2032-Batterien einlegen
3. Wieder festschrauben

1.

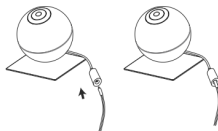

2.

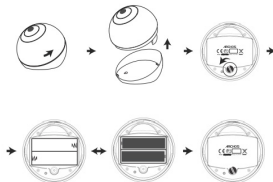

3.





DE

ARCHOS WEATHER STATION - Ersteinrichtung

Nach dem ersten Start der App muss die Weather Station verbunden werden.

1. Laden Sie die ARCHOS Weather Station App von Google Play oder Apple Store herunter
2. Das WLAN von Smartphone oder Tablet einschalten.
3. Die App ARCHOS Weather Station starten
4. Suchen Sie nach ARCHOS Weather Stations, indem Sie auf "Connect your **Weather Station** (Weather Station verbinden)" klicken und Ihre Station auswählen.

Eine neue Weather Station muss eingeschaltet sein, damit sie von der Anwendung erkannt werden kann, und einmal ausgewählt, muss die LED blau blinken. Blinkt die LED nach wenigen Minuten nicht, drücken Sie die Taste auf der Unterseite der Station solange, bis sie blau blinkt.

5. Wählen Sie Ihr WLAN-Netzwerk und senden Sie das Passwort zur Wetterstation, damit diese mit dem Internet verbunden werden kann.
6. Warten Sie, bis die Wetterstation verbunden ist.
7. Registrieren Sie Ihre Weather Station und geben Sie Ihre Daten ein: Standort, Name





ARCHOS WEATHER STATION - Ersteinrichtung

DE

Sobald die Weather Station verbunden ist, fügen Sie neue Sensoren hinzu.

Paarung des Außenmoduls

1. Prüfen Sie, ob die AA-Batterien korrekt eingelegt sind.
2. Sobald sich die Batterien im Modul befinden, wird der Paarungsmodus gestartet.
3. Klicken Sie in der Anwendung auf "Add a new sensor (Neuen Sensor hinzufügen)".
4. Paarung erfolgreich, wenn nicht, den Vorgang wiederholen und die Reset-Taste drücken.

Paarung des Bodenmoduls

1. Prüfen Sie, ob die CR2032-Batterien korrekt eingelegt sind.
2. Sobald sich die Batterien im Modul befinden, wird der Paarungsmodus gestartet.
3. Klicken Sie in der Anwendung auf "**Add a new sensor (Neuen Sensor hinzufügen)**".
4. Paarung erfolgreich, wenn nicht, den Vorgang wiederholen und die Reset-Taste drücken.



DE

ARCHOS WEATHER STATION - Benutzeroberfläche

1. Wettervorhersage für die nächsten 6 Tage

2. Innensensoren

- A. Temperatur
- B. Luftfeuchtigkeit:
- C. Luftdruck
- D. CO2-Gehalt
- E. Geräuschpegel

3. Außensensoren

- A. Temperatur
- B. Luftfeuchtigkeit:

4. Bodensensoren

- A. Temperatur
- B. Luftfeuchtigkeit:

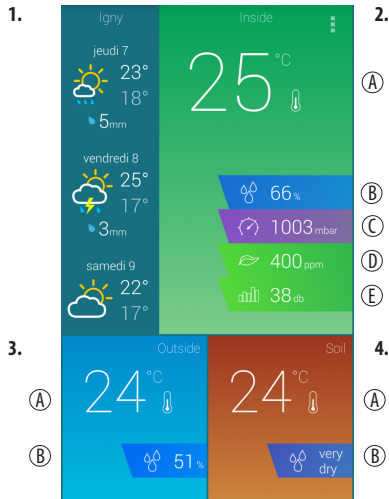



ARCHOS WEATHER STATION - Stationsverwaltung

DE

Sobald eine Verbindung mit Ihrer ARCHOS Weather Station Application besteht, können die Modulsensoren jederzeit überprüft werden.

1. Wählen Sie den Modulsensor von Interesse und tippen Sie auf dessen Symbol.
2. Wählen Sie Ihre Skala (1h, 2h, 6h, 12h, 1 Tag, 2 Tage, 1 Woche).
3. Folgen Sie der Entwicklung im Zeitverlauf und vergleichen Sie anhand der von der Anwendung bereitgestellten Grafiken vorherige Tage/Monate/Jahre. Für jeden Sensor wird eine eigene Grafik angezeigt.

①



②

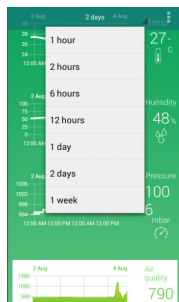

③

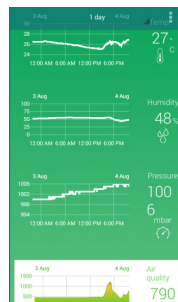

ARCHOS WEATHER STATION - Stationsverwaltung

Es können zu jedem Zeitpunkt Weather Stations hinzugefügt oder entfernt werden.

Hinzufügen einer Weather Station

1. Starten Sie die App ARCHOS Weather Station.
2. Tippen Sie auf (Symbol mit den 3 Punkten) und wählen Sie **Station Manager**.
3. Wählen Sie 'Find stations (Stationen suchen)'
4. Sie werden zur Homepage von ARCHOS Weather Station weitergeleitet.
5. Wählen Sie "Connect your Weather Station (Weather Station verbinden)"
6. Wählen Sie die hinzuzufügende Station.
7. Tippen Sie auf (Symbol mit 3 Punkten) und wechseln Sie zwischen den Stationen, indem Sie die gewünschte Station auswählen.

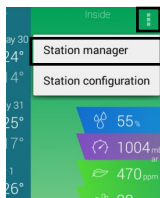

②

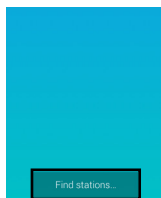

③

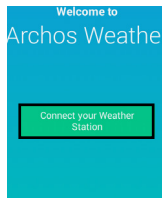

⑤

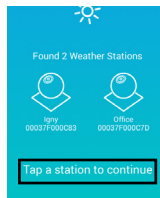

⑥

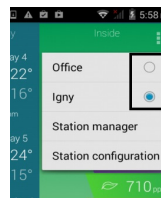

⑦



ARCHOS WEATHER STATION - Stationsverwaltung

DE

Entfernen einer Weather Station von der App

1. Starten Sie die App ARCHOS Weather Station.
2. Wählen Sie Station Manager im Parametermenü.
3. Wählen Sie eine Station, indem Sie mehrere Sekunden auf deren Name drücken.
4. Wählen Sie "Unregister (Registrierung löschen)".

②

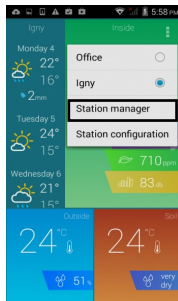

③

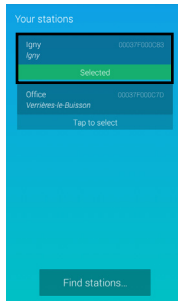

④

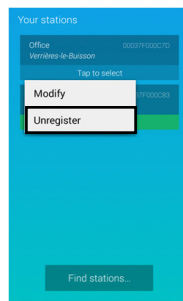



DE

ARCHOS WEATHER STATION - Stationsverwaltung

Verbindung Ihrer Weather Station mit einem anderen WLAN-Netzwerk

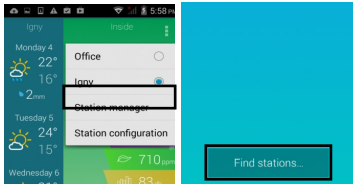
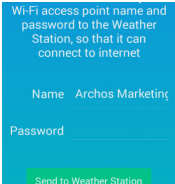
1. Starten Sie die App ARCHOS Weather Station.
2. Fahren Sie mit der Hand über das Innenmodul für die Anzeige der grünen LED für die Luftqualität.
3. Halten Sie Ihre Hand mindestens 15 Sekunden lang über das Innenmodul.
4. Das Innenmodul blinkt jetzt blau und die Station wechselt in den Zugriffspunktmodus.
5. Tippen Sie auf (Symbol), wählen Sie Station Manager und dann 'Find stations (Stationen suchen)'.
6. Wählen Sie Ihr WLAN-Netzwerk und senden Sie das Passwort zur Weather Station, damit diese mit dem Internet verbunden werden kann.
7. Während die Weather Station verbindet, blinkt das Innenmodul rot.
8. Die Weather Station muss nicht neu registriert werden.

TIPPS:

Wird dieser Modus versehentlich ausgelöst, ein paar Minuten warten und keine Aktivität auf der ARCHOS Weather Station ausführen und diese wird neu verbinden.



ARCHOS WEATHER STATION - Modulverwaltung

DE

Hinzufügen/Entfernen eines ARCHOS Weather Station-Sensors

1. Starten Sie die App ARCHOS Weather
2. Die Sensoren müssen sich im Paarungsmodus befinden.
3. Tippen Sie auf (Symbol) und wählen Sie "Station Configuration (Stationskonfiguration)" (Abbildung 1)
4. Wählen Sie "Add or Remove a peripheral (Peripherie hinzufügen oder entfernen)" (Abbildung 2)

Neuen Sensor hinzufügen

1. Wählen Sie "Add a new sensor (Neuen Sensor hinzufügen)" (Abbildung 3)
2. Erfolgreich, wenn nicht, Batterien auf korrektes Einlegen hin überprüfen und neu versuchen.

Sensor entfernen

1. Drücken Sie auf das Symbol des zu entfernenden Sensors (Abbildung 4).
2. Klicken Sie auf OK, um den Sensor zu entfernen (Abbildung 5).

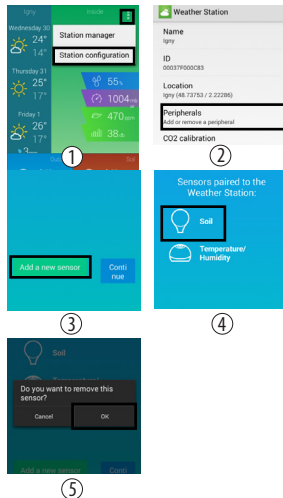



DE

Fehlerbehebung

Warum ist eine Verbindung von der Weather Station zum Mobilgerät nicht möglich?

Überprüfen Sie, ob Mobilgerät und Weather Station mit dem selben WLAN verbunden sind.

Überprüfen Sie, ob Ihr Gerät mit der Weather Station gepaart wurde.

Warum reagieren meine Sensoren nicht? Es sind keine Daten oder keine aktualisierten Daten vorhanden. Wurden die Sensoren korrekt mit der ARCHOS Weather Station gepaart?

Diese Informationen können unter 'Station Configuration' < 'Peripherals' (Stationskonfiguration < Peripherie) überprüft werden. Prüfen Sie, ob WLAN in Ihrem Gerät aktiviert ist. Überprüfen Sie den Ladezustand der Batterien von Außenmodul und Bodenmodul. Bei leeren Batterien diese ersetzen.

Überprüfen Sie, ob der Abstand Ihrer Sensoren zum Innenmodul zu groß ist.

Wie kann ich die Weather Station auf die Standardeinstellungen zurücksetzen?

Drücken Sie die Reset-Taste auf der Unterseite Ihrer ARCHOS Weather Station.

Öffnen Sie die Einstellungen der ARCHOS Weather Application: 'Station manager' < 'Select a station' < 'Unregister (Station Manager < Station wählen < Registrierung löschen)





Índice

ES

Contenido de la caja.....	34
Módulo de interior ARCHOS.....	35
Módulo de exterior ARCHOS.....	37
Módulo de suelo ARCHOS.....	38
Primeros pasos.....	39
Estación meteorológica ARCHOS- Configuración inicial.....	40
Estación meteorológica ARCHOS- Interfaz.....	42
Estación meteorológica ARCHOS- Gestión de estaciones.....	43
Estación meteorológica ARCHOS- Gestión de módulos.....	47
Resolución de problemas.....	48

Para más información, consulte la sección de preguntas y respuestas de su producto en www.archos.com. Exámínela detenidamente antes de pensar en realizar cualquier devolución. Los procedimientos pueden variar dependiendo de las actualizaciones del producto.

Consulte la declaración de conformidad en http://www.archos.com/products/declaration_conformity.html



Contenido de la caja

ES



Módulo de interior ARCHOS



Módulo de exterior ARCHOS



Módulo de suelo ARCHOS



2 pilas AA



2 pilas CR2032



Adaptador CA



Folleto de inicio rápido



Folleto de seguridad y
garantía legal





Módulo de interior ARCHOS

Descripción del módulo de interior

1. Botón Restablecer
2. LED de emparejamiento y calidad de aire
3. Conector de alimentación

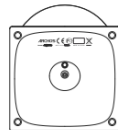

ES

ACCIÓN	PILOTO LED
Módulo en modo emparejamiento a la espera de conectarse a dispositivo	El LED parpadea en azul
Móvil conectado correctamente al módulo	LED en azul siempre encendido

El piloto LED le informará del estado del dispositivo cada vez que vaya a conectar el módulo interior o durante el uso.

ACCIÓN	PILOTO LED
Módulo en modo emparejamiento e intentando conectarse	El LED emite un destello azul casi justo después de encender
Módulo intentando conectarse o fallo en conexión	El LED parpadea en rojo
Módulo conectado correctamente	El LED se enciende en verde durante 10 s

35





Módulo de interior ARCHOS

ES

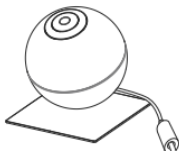

LED de indicador de estado

Pase la mano sobre el LED para comprobar el nivel de CO₂ y conocer así la calidad de aire en su hogar (en función del color del LED).

COLOR	CALIDAD DEL AIRE
Verde	Buena calidad
Amarillo	Calidad mejorable
Rojo	Ventile la habitación





Módulo de exterior ARCHOS

Descripción del módulo de exterior

ES

1. Indicador de emparejamiento

El emparejamiento se realiza al insertar las pilas. Si no fuera así, apriete el botón de restablecer para activar el modo de emparejamiento.

2. Base

3. Botón Restablecer

4. Portapilas

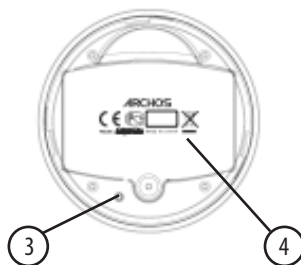
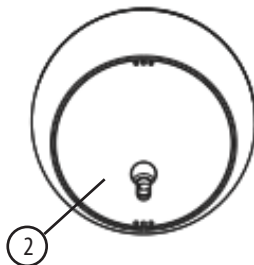
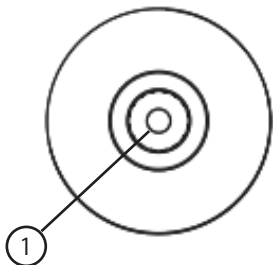



Módulo de suelo ARCHOS

ES

Descripción del módulo de suelo

1. Botón Restablecer
2. Sensor de temperatura y humedad
3. Compartimento de pilas

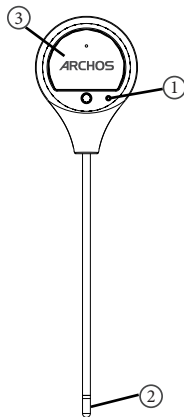



Primeros pasos

1. Conecte el cable de alimentación a la toma de alimentación del módulo de interior.



El dispositivo principal debe estar conectado en todo momento a la corriente eléctrica

2. Descargue la aplicación ARCHOS Weather Station de Google Play Store o Apple Store y siga el asistente de configuración.

3. Habilite el módulo de exterior.

1. Desatornille el módulo de exterior
2. Desatornille el compartimento de pilas
3. Coloque dos pilas AA
4. Vuelva a atornillar el compartimento y cierre el módulo

4. Habilite el sensor de suelo

1. Desatornille el compartimento de pilas
2. Coloque dos pilas CR2032
3. Vuelva a atornillar

1.

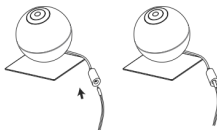

2.

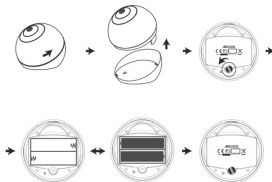

3.



ES



Estación meteorológica ARCHOS- Configuración inicial

ES

La primera vez que abra la aplicación, deberá conectarla a la estación meteorológica.

1. Descargue la aplicación ARCHOS Weather Station de Google Play o Apple Store
2. Active la conexión WiFi en su smartphone o tableta.
3. Abra la aplicación ARCHOS Weather Station
4. Haga clic en "Connect your **Weather Station**" (Conectar estación meteorológica) y luego seleccione su estación Archos.

Para que la aplicación la reconozca, la nueva estación meteorológica debe estar encendida. Una vez seleccionada con la aplicación, el piloto LED parpadeará en azul. Si pasaran unos minutos y el piloto no parpadeara, mantenga apretado el botón en la parte inferior de la estación hasta que la luz parpadee en azul.

5. Seleccione su red Wifi y envíe la contraseña a la estación meteorológica para que pueda conectarse a internet.
6. Espere mientras la estación se conecta.
7. Registre su estación meteorológica e introduzca sus datos: ubicación, nombre



Estación meteorológica ARCHOS- Configuración inicial

ES

Una vez la estación meteorológica conectada, añada los sensores.

Para emparejar el módulo de exterior

1. Asegúrese de insertar correctamente las dos pilas AA.
2. El modo de emparejamiento se activará al insertar las pilas en el módulo.
3. En la aplicación, haga clic en "add a new sensor" (añadir nuevo sensor).
4. Si el emparejamiento no es correcto, repita de nuevo el proceso y apriete el botón de restablecimiento.

Para emparejar el módulo de suelo

1. Asegúrese de insertar correctamente las dos pilas CR2032.
2. El modo de emparejamiento se activará al insertar las pilas en el módulo.
3. En la aplicación, haga clic en "add a new sensor" (añadir nuevo sensor).
4. Si el emparejamiento no es correcto, repita de nuevo el proceso y apriete el botón de restablecimiento.



Estación meteorológica ARCHOS - Interfaz

ES

1. Previsión meteorológica para los próximos 6 días

2. Sensores de interior

- A. Temperatura
- B. Humedad
- C. Presión atmosférica
- D. Nivel de CO2
- E. Nivel de ruido

3. Sensores de exterior

- A. Temperatura
- B. Humedad

4. Sensores de suelo

- A. Temperatura
- B. Humedad

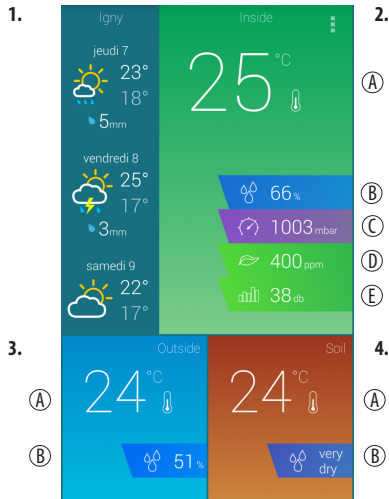



Estación meteorológica ARCHOS- Gestión de estaciones

Puede consultar los datos de los sensores de sus módulos en cualquier momento utilizando la aplicación Archos Weather Station.

ES

1. Seleccione el sensor del módulo que quiera ver y pulse en su icono.
2. Seleccione una franja temporal (1 h, 2 h, 6 h, 12 h, 1 día, 2 días, 1 semana).
3. Puede seguir la evolución a lo largo del tiempo y compararla con la de días, meses o años atrás mediante las gráficas que ofrece la aplicación. Cada sensor dispone de su gráfica específica.

①



②

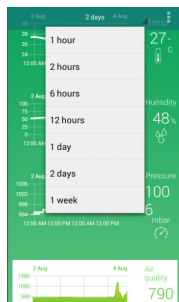

③

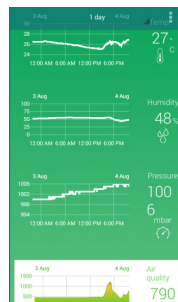



Estación meteorológica ARCHOS- Gestión de estaciones

ES

Puede añadir o quitar estaciones meteorológicas en cualquier momento.

Para añadir una estación meteorológica

1. Abra la aplicación Archos Weather Station.
2. Pinche en (icono de 3 puntos) y seleccione **"Station Manager"** (Gestor de estaciones).
3. Seleccione **"Find stations"** (Encontrar estaciones).
4. Se mostrará la página inicial de ARCHOS Weather Station.
5. Seleccione **"Connect your Weather Station"** (Conectar estación meteorológica)
6. Seleccione la estación que desee añadir.
7. Pinche en (icono de 3 puntos) para ver sus estaciones y seleccionar una.

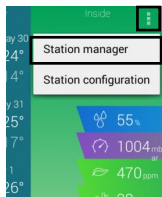

②

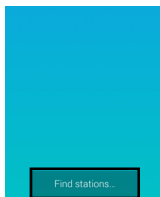

③

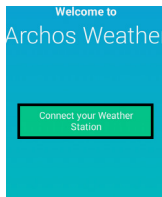

⑤

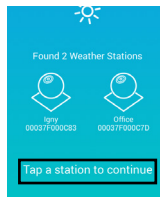

⑥

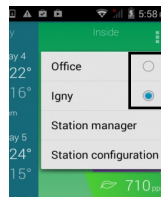

⑦





Estación meteorológica ARCHOS- Gestión de estaciones

Para quitar una estación meteorológica de la aplicación

1. Abra la aplicación Archos Weather Station.
2. Seleccione "Station Manager" (Gestor de estaciones) en el menú de parámetros.
3. Para seleccionar una estación, mantenga pulsado sobre su nombre.
4. Seleccione "Unregister" (Dar de baja).

ES

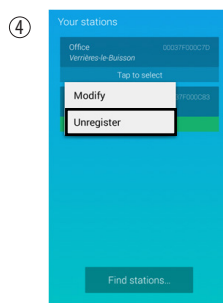
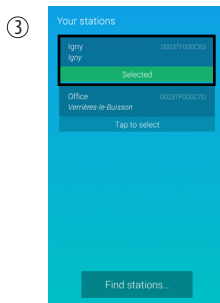
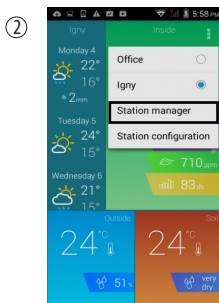



Estación meteorológica ARCHOS- Gestión de estaciones

ES

Para conectar su estación meteorológica a otra red Wifi

1. Abra la aplicación Archos Weather Station.
2. Pase la mano sobre el módulo de interior para ver el piloto verde de calidad de aire.
3. Mantenga la mano sobre el módulo de interior durante al menos 15 segundos.
4. El módulo de interior parpadeará en azul y la estación pasará a modo Punto de Acceso.
5. Pinche en (icono), seleccione "Station Manager" (Gestor de estaciones) y luego "Find stations" (Encontrar estaciones).
6. Seleccione su red Wifi y envíe la contraseña a la estación meteorológica para que pueda conectarse a internet.
7. El módulo de interior parpadeará en rojo mientras la estación meteorológica se conecta.
8. No necesita volver a registrar la estación.

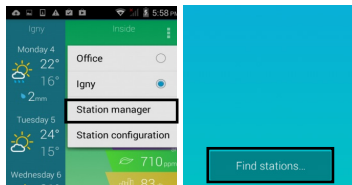

⑤

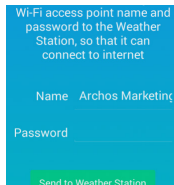

⑥

CONSEJOS:

Si activa este modo por accidente, espere sin realizar ninguna acción en la app ARCHOS Weather Station y tras unos pocos minutos se reconectará de forma automática



Estación meteorológica ARCHOS- Gestión de módulos

Para añadir o quitar un sensor de la estación meteorológica ARCHOS

1. Abra la aplicación ARCHOS Weather Station
2. Compruebe que los sensores estén en modo emparejamiento
3. Pinche en (icono) y seleccione "Station Configuration" (Configuración estación) (figura 1)
4. Seleccione "Add or Remove a peripheral" (Añadir o quitar periférico) (figura 2)

Para añadir un nuevo sensor

1. Seleccione Add a new sensor (Añadir nuevo sensor) (figura 3)
2. Si no funcionara, compruebe que las pilas estén insertadas correctamente y pruebe de nuevo

Para quitar un sensor

1. Pulse el icono del sensor que desee quitar (figura 4)
2. Haga clic en "OK" (Aceptar) para quitar el sensor (figura 5)



ES



Resolución de problemas

ES

¿Por qué no me puedo conectar a la estación meteorológica con mi dispositivo móvil?

Compruebe que tanto su dispositivo móvil como la estación meteorológica estén conectados a la misma WiFi.

Compruebe que su dispositivo esté emparejado con la estación meteorológica

¿Por qué los sensores no responden? Puede que no dispongan de datos o no haya ninguna actualización de datos.

¿Están emparejados correctamente con su estación meteorológica Archos? Puede consultar esto en "Station Configuration" (Configuración de estación) < "Peripherals". Verifique que la Wifi esté activada en su dispositivo. Compruebe que las pilas del módulo de exterior y del sensor de suelo no estén gastadas. Si lo estuvieran, cámbielas por otras nuevas.

Asegúrese de que los sensores estén lo suficientemente cerca del módulo de interior.

¿Cómo puedo restablecer la estación meteorológica a los parámetros de fábrica?

Aprete el botón de restablecer en la parte inferior de su estación meteorológica ARCHOS.

En los ajustes de la aplicación ARCHOS Weather, seleccione: "Station manager" (Gestor de estaciones) < "Select a station" (Seleccionar estación) < "Unregister" (Dar de baja)



Indice

Contenuto della confezione.....	50
Modulo interno ARCHOS	51
Modulo esterno ARCHOS.....	53
Modulo al suolo ARCHOS.....	54
Per iniziare.....	55
Stazione meteorologica ARCHOS - Impostazioni iniziali.....	56
Stazione meteorologica ARCHOS - Interfaccia.....	58
Stazione meteorologica ARCHOS - Gestione delle stazioni.....	59
Stazione meteorologica ARCHOS - Gestione dei moduli.....	63
Diagnosi dei guasti.....	64

IT

Per maggiori informazioni, consultare le FAQ sul prodotto in www.archos.com. Si raccomanda di leggere queste informazioni prima di decidere l'eventuale restituzione del prodotto. Le procedure possono cambiare a seguito di aggiornamenti dell'applicazione.

Consultare la dichiarazione di conformità su http://www.archos.com/products/declaration_conformity.html



Contenuto della confezione

IT



Modulo interno ARCHOS



Modulo esterno ARCHOS



Modulo al suolo ARCHOS



2 batterie AA



2 batterie CR2032



Adattatore AC



Guida Rapida



Garanzia,
Informazioni legali e
sulla sicurezza





Modulo interno ARCHOS

Descrizione del modulo interno

1. Pulsante di reset
2. Indicatore di pairing e LED di qualità dell'aria
3. Connettore elettrico

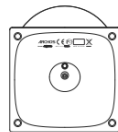

IT

AZIONE	STATO DEL LED
Modulo in modalità di pairing e in attesa di essere collegato al dispositivo	LED lampeggiante blu
Dispositivo mobile correttamente collegato al modulo	LED blu acceso fisso

LED indicatori di stato ogni volta che si vuole ricollegare il modulo interno o durante l'uso.

AZIONE	STATO DEL LED
Modulo in modalità di pairing e tentativo di connessione	Il LED lampeggia con luce blu quasi immediatamente dopo l'inserimento dell'alimentazione elettrica
Il modulo sta tentando di connettersi o ha perso la connessione	LED lampeggiante rosso
Il modulo si collega correttamente	LED verde acceso per 10 s

51





Modulo interno ARCHOS

IT

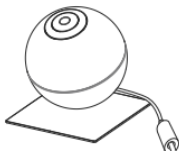

LED indicatore di stato

Passare la mano sul LED e verificare il livello di CO2 in base al colore del LED per valutare la qualità dell'aria dell'ambiente domestico.

COLORE	QUALITÀ DELL'ARIA
Verde	Buona qualità
Giallo	La qualità è migliorabile
Rosso	L'ambiente deve essere ventilato





Modulo esterno ARCHOS

Descrizione del modulo esterno

1. Indicatore di pairing

Il pairing avviene all'inserimento delle batterie. In caso contrario, utilizzare il pulsante di reset per attivare la modalità di pairing.

2. Base

3. Pulsante di reset

4. Portabatteria

IT

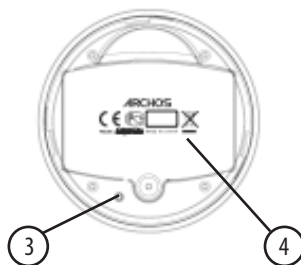
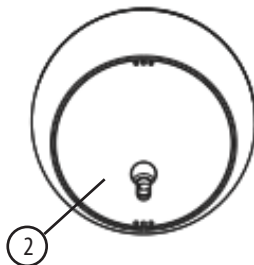
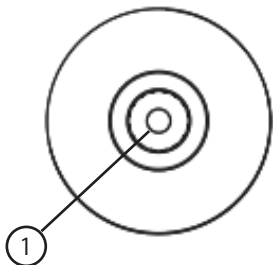



Modulo al suolo ARCHOS

Descrizione del modulo al suolo

IT

1. Pulsante di reset
2. Sensore di temperatura e umidità
3. Vano batterie

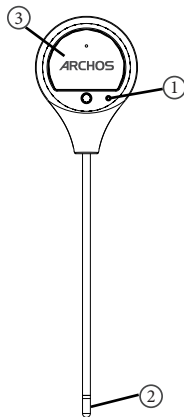



Per iniziare

1. Collegare il cavo di alimentazione al connettore elettrico del modulo interno.



Il dispositivo principale deve essere sempre collegato all'alimentazione elettrica

2. Scaricare l'applicazione della stazione meteorologica ARCHOS da Google Play Store o Apple Store e seguire la procedura di configurazione.

3. Mettere in funzione il modulo esterno.

1. Aprire il modulo esterno
2. Aprire il vano batterie
3. Inserire due batterie AA
4. Richiudere il vano e chiudere il modulo

4. Mettere in funzione il sensore al suolo

1. Aprire il vano batterie
2. Inserire due batterie CR2032
3. Richiudere

1.

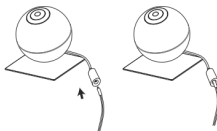

2.

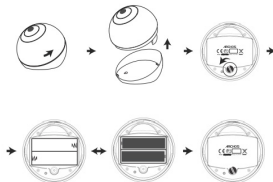

3.



IT



STAZIONE METEOROLOGICA ARCHOS - Impostazioni iniziali

IT

La prima volta che si lancia l'applicazione è necessario collegare la stazione meteorologica.

1. Scaricare l'applicazione della stazione meteorologica ARCHOS da Google Play Store o da Apple Store
2. Attivare il WiFi sullo smartphone o sul tablet.
3. Lanciare l'app della stazione meteorologica ARCHOS
4. Cercare le stazioni meteorologiche Archos facendo clic su Connect your **Weather Station** e quindi selezionare la propria stazione.

Una nuova stazione meteorologica deve essere accesa per essere riconosciuta dall'applicazione e, una volta selezionata, il LED deve lampeggiare con luce blu. Se questo non accade dopo alcuni minuti, mantenere la pressione sul pulsante sotto la stazione finché non si accende la luce blu lampeggiante.

5. Selezionare la propria rete WiFi ed inviare la password alla stazione meteorologica perché si possa connettere a Internet.
6. Attendere che la stazione meteorologica si connetta.
7. Registrare la stazione meteorologica e impostare i propri dati: luogo, nome



STAZIONE METEOROLOGICA ARCHOS - Impostazioni iniziali

Aggiungere nuovi sensori quando la stazione meteorologica è collegata.

Pairing del modulo esterno

1. Accertarsi che le due batterie AA siano ben posizionate nel proprio supporto.
2. Quando le batterie vengono inserite nel modulo, questo entra in modalità di pairing.
3. Fare clic su "add a new sensor" nell'applicazione.
4. Se il pairing non avviene, ripetere la procedura e premere il pulsante di reset.

Pairing del modulo al suolo

1. Accertarsi che le due batterie CR2032 siano ben posizionate nel proprio supporto.
2. Quando le batterie vengono inserite nel modulo, questo entra in modalità di pairing.
3. Fare clic su "**add a new sensor**" nell'applicazione.
4. Se il pairing non avviene, ripetere la procedura e premere il pulsante di reset.

IT



STAZIONE METEOROLOGICA ARCHOS - Interfaccia

IT

1. Previsione meteorologica per i 6 giorni successivi

2. Sensori interni

- A. Temperatura
- B. Umidità
- C. Pressione atmosferica
- D. Livello di CO2
- E. Livello di rumore

3. Sensori esterni

- A. Temperatura
- B. Umidità

4. Sensori al suolo

- A. Temperatura
- B. Umidità

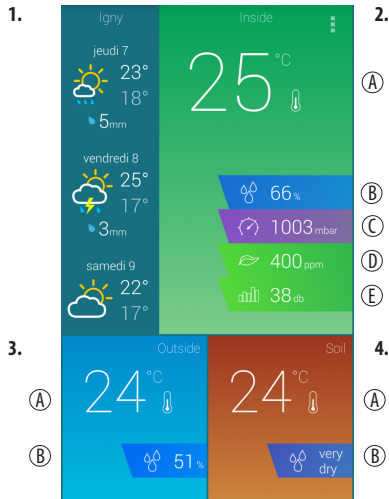



STAZIONE METEOROLOGICA ARCHOS - Gestione delle stazioni

Dall'applicazione della stazione meteorologica Archos è possibile controllare i dati dei sensori dei moduli in qualsiasi momento.

1. Selezionare il sensore del modulo che interessa e toccare la relativa icona.
2. Selezionare la scala desiderata (1h, 2h, 6h, 12h, 1 giorno, 2 giorni, 1 settimana).
3. Seguire l'evoluzione nel tempo e confrontare i giorni/mesi/anni precedenti utilizzando i grafici forniti dall'applicazione. Ogni sensore ha un grafico dedicato.

IT

①



②

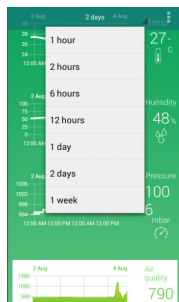

③

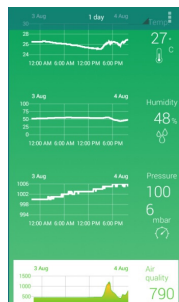



STAZIONE METEOROLOGICA ARCHOS - Gestione delle stazioni

IT

È possibile aggiungere o rimuovere stazioni meteorologiche in qualsiasi momento.

Per aggiungere una stazione meteorologica

1. Lanciare la app della stazione meteorologica Archos
2. Toccare (icona con i 3 punti) e selezionare **Station Manager**.
3. Selezionare Find stations.
4. Si viene reindirizzati alla home page della stazione meteorologica ARCHOS.
5. Selezionare Connect your Weather Station.
6. Selezionare la stazione che si vuole aggiungere.
7. Toccare (icona con 3 punti) e passare da una stazione all'altra selezionando quella desiderata.

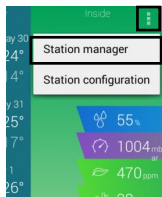

②

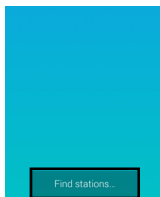

③

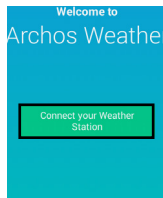

⑤

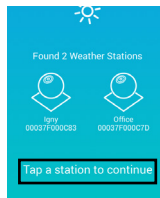

⑥

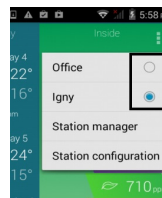

⑦





STAZIONE METEOROLOGICA ARCHOS - Gestione delle stazioni

Per eliminare una stazione meteorologica dalla app

1. Lanciare la app della stazione meteorologica Archos.
2. Selezionare Station manager nel menu parametri.
3. Selezionare una stazione esercitando una pressione prolungata sul suo nome.
4. Selezionare Unregister.

IT

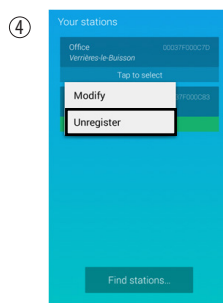
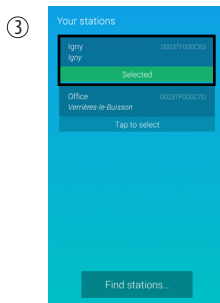
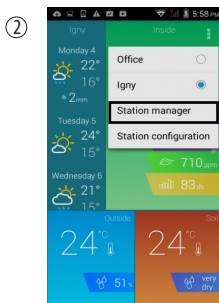



STAZIONE METEOROLOGICA ARCHOS - Gestione delle stazioni

IT

Per collegare la stazione meteorologica a un'altra rete Wifi

1. Lanciare la app della stazione meteorologica ARCHOS.
2. Passare la mano sul modulo interno per visualizzare l'indicatore luminoso verde di qualità dell'aria.
3. Tenere la mano sul modulo interno per almeno 15 secondi.
4. Si attiverà la luce lampeggiante blu del modulo interno e la stazione passerà in modalità Access Point.
5. Toccare (icona), quindi selezionare Station Manager e Find stations.
6. Selezionare la propria rete WiFi ed inviare la password alla stazione meteorologica perché si possa collegare a Internet.
7. Quando la stazione meteorologica sta effettuando il collegamento, si attiva la luce lampeggiante rossa del modulo interno.
8. Non è necessario registrare nuovamente la stazione meteorologica.

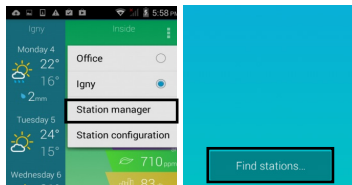

⑤

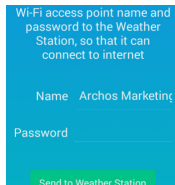

⑥

SUGGERIMENTO:

Se si attiva questa modalità accidentalmente, è sufficiente attendere qualche minuto e la stazione meteorologica ARCHOS si riconnetterà automaticamente



STAZIONE METEOROLOGICA ARCHOS - Gestione dei moduli

Per aggiungere/rimuovere un sensore della stazione meteorologica ARCHOS

1. Lanciare la app meteorologica ARCHOS
2. Verificare che i sensori siano in modalità di pairing
3. Toccare (icona) e selezionare Station Configuration (figura 1)
4. Selezionare Add or Remove a peripheral (figura 2)

Per aggiungere un nuovo sensore

1. Selezionare Add a new sensor (figura 3)
2. Se l'operazione non ha successo, verificare che le batterie siano inserite e tentare nuovamente

Per rimuovere un sensore

1. Premere l'icona del sensore che si vuole rimuovere (figura 4)
2. Fare clic su OK per rimuovere il sensore (figura 5)

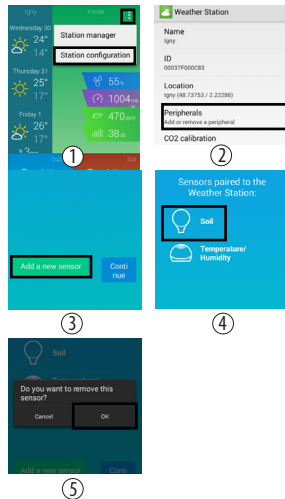



Diagnosi dei guasti

IT

Perché non riesco a connettermi alla stazione meteorologica con il mio dispositivo mobile?

Verificare che il dispositivo mobile e la stazione meteorologica siano collegati alla stessa rete WiFi.

Verificare che sia avvenuto il riconoscimento tra il dispositivo e la stazione meteorologica

Perché i sensori non rispondono? Nessun dato o nessun dato aggiornato. Sono stati correttamente riconosciuti dalla stazione meteorologica Archos? È possibile verificare queste informazioni in 'Station Configuration' < 'Peripherals' Check se il Wifi è attivo sul dispositivo. Verificare che le batterie di alimentazione del modulo esterno e del sensore al suolo non siano scariche. In questo caso, è necessario sostituirle.

Verificare che i sensori siano sufficientemente vicini al modulo interno.

Come si ripristinano le impostazioni predefinite della stazione meteorologica?

Utilizzare il pulsante di reset sotto la stazione meteorologica ARCHOS.

Accedere alle impostazioni dell'applicazione meteorologica ARCHOS: 'Station manager' < 'Select a station' < 'Unregister



Inhoudsopgave

Inhoud van de verpakking.....	66
ARCHOS binnenmodule.....	67
ARCHOS buitenmodule.....	69
ARCHOS grondmodule.....	70
Aan de slag.....	71
ARCHOS Weather Station - Eerste installatie.....	72
ARCHOS Weather Station - Interface.....	74
ARCHOS Weather Station - Stations beheren.....	75
ARCHOS Weather Station - Modules beheren.....	79
Probleemoplossing.....	80

Raadpleeg voor meer informatie de veelgestelde vragen (FAQ's) over uw product op www.archos.com. Lees eerst de antwoorden op deze vragen voordat u het product terugstuurt. Als gevolg van updates van de toepassing kunnen de procedures wijzigen.

Raadpleeg de verklaring van overeenstemming op http://www.archos.com/products/declaration_conformity.html

NL



Inhoud van de verpakking



ARCHOS binnenmodule



ARCHOS buitenmodule



ARCHOS grondmodule

NL



2 x AA batterijen



2 x CR2032 batterijen



AC-adaptor



Verkorte handleiding



Garantie
& veiligheidsinformatie





ARCHOS binnenmodule

Beschrijving van de binnenmodule

1. Reset-knop
2. Pairing-lampje
3. Voedingsaansluiting



BEWERKING	LED-STATUS
De module is in de pairing-modus en wacht op verbinding met het apparaat	De LED knippert blauw
Mobiel verbonden met module	Blauwe LED brandt voortdurend

LED-statuslampjes bij opnieuw verbinden van uw binnenmodule of tijdens gebruik.

BEWERKING	LED-STATUS
De module is in de pairing-modus en probeert verbinding te maken	Blauwe LED knippert vrijwel onmiddellijk na inschakelen
De module probeert verbinding te maken of de verbinding is verbroken	De LED knippert rood
Module is verbonden	Groene LED brandt gedurende 10 sec.

NL



ARCHOS binnenmodule

NL

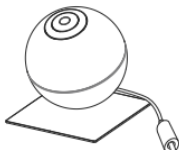

LED-statuslampje

Beweeg uw hand over de LED en controleer het CO₂-niveau aan de hand van de LED-kleur om de luchtkwaliteit in uw huis te bepalen.

KLEUR	LUCHTKWALITEIT
Groen	Goede kwaliteit
Geel	Kwaliteit kan beter
Rood	Ruimte moet worden geventileerd





ARCHOS buitenmodule

Beschrijving van de buitenmodule

1. Pairing-lampje

Pairing (koppelen) wordt uitgevoerd als de batterijen worden geplaatst. Als dit niet het geval is, druk dan op de Reset-knop om de paring-modus te activeren.

2. Basis

3. Reset-knop

4. Batterijcompartiment

NL

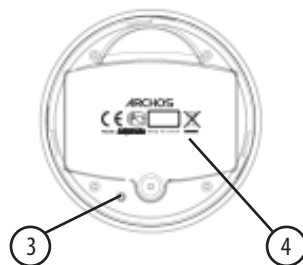
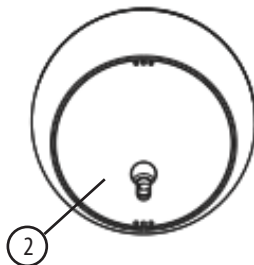
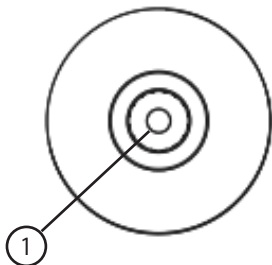



ARCHOS grondmodule

Beschrijving van de grondmodule

1. Reset-knop
2. Temperatuur- en vochtigheidssensor
3. Batterijcompartiment

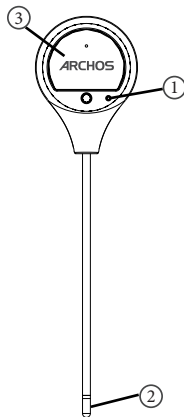

NL



Aan de slag

1. Sluit de voedingskabel aan op de voedingsaansluiting van de binnenmodule.



Uw hoofdapparaat moet permanent zijn aangesloten op het lichtnet.

2. Download de ARCHOS Weather Station app in de Google Play Store of Apple Store en volg de configuratiestappen.

3. Schakel de buitenmodule in.

1. Schroef de buitenmodule los.
2. Schroef het batterijcompartiment los.
3. Plaats twee AA batterijen.
4. Schroef het batterijcompartiment weer vast en sluit de module

4. Schakel de grondmodule in.

1. Schroef het batterijcompartiment los.
2. Plaats twee CR2032 batterijen.
3. Schroef het batterijcompartiment weer vast.

1.

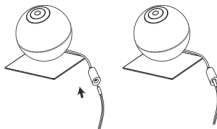

2.

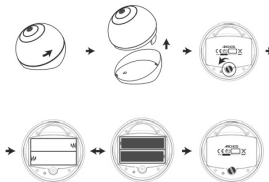

3.



NL



ARCHOS WEATHER STATION - Eerste installatie

Bij de eerste installatie van de app moet u verbinding maken met uw Weather Station.

1. Download de ARCHOS Weather Station App in de Google Play of Apple Store
2. Schakel WiFi in op uw smartphone of tablet.
3. Open de ARCHOS Weather Station App
4. Zoek naar Archos Weather Stations door op Connect your **Weather Station** [Verbinding maken met Weather Station] te tikken en dan uw apparaat te kiezen.

Om te worden herkend door de applicatie moet het nieuwe Weather Station zijn ingeschakeld. Na de selectie moet de LED blauw knipperen. Als dit niet gebeurt, druk dan na enkele minuten lang op de knop onder het station totdat het lampje blauw gaat knipperen.

5. Kies uw WiFi-netwerk en stuur het wachtwoord naar het Weather Station zodat het apparaat verbinding kan maken met het internet.
6. Wacht totdat uw Weather Station verbinding heeft gemaakt.
7. Registreer uw Weather Station en stel uw gegevens in: locatie, naam

NL



ARCHOS WEATHER STATION - Eerste installatie

Wanneer uw Weather Station is verbonden, kunt u nieuwe sensoren toevoegen.

Pairing van de buitenmodule

1. Zorg ervoor dat de twee AA batterijen goed in hun houder zijn geplaatst.
2. Zodra de batterijen in de module zijn geplaatst, wordt de pairing-modus geactiveerd.
3. Klik op "add a new sensor" [nieuwe sensor toevoegen] in uw applicatie.
4. De paring is uitgevoerd. Zo niet, herhaal dan het proces en druk op de Reset-knop.

Pairing van de grondmodule

1. Zorg ervoor dat de twee CR2032 batterijen goed in hun houder zijn geplaatst.
2. Zodra de batterijen in de module zijn geplaatst, wordt de pairing-modus geactiveerd.
3. Klik op "**add a new sensor**" [nieuwe sensor toevoegen] in uw applicatie.
4. De paring is uitgevoerd. Zo niet, herhaal dan het proces en druk op de Reset-knop.

NL



ARCHOS WEATHER STATION - Interface

1. Weersverwachtingen voor de komende 6 dagen

2. Binnensensoren

- A. Temperatuur
- B. Vochtigheid
- C. Luchtdruk
- D. CO₂-niveau
- E. Geluidsniveau

3. Buitensensoren

- A. Temperatuur
- B. Vochtigheid

4. Grondsensoren

- A. Temperatuur
- B. Vochtigheid

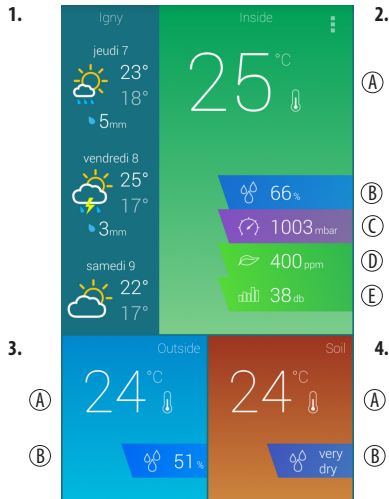

NL



ARCHOS WEATHER STATION - Stations beheren

Nadat u verbinding heeft gemaakt met de Archos Weather Station app kunt u op ieder moment de sensorinformatie van de modules controleren.

1. Kies de gewenste modulesensor en tik op het pictogram van de sensor.
2. Kies de tijdsspanne (1 uur, 2 uur, 6 uur, 12 uur, 1 dag, 2 dagen, 1 week).
3. Volg de ontwikkeling gedurende de tijdsspanne en vergelijk deze met eerdere dagen/maanden/jaren door middel van de grafieken in de app. Iedere sensor heeft zijn eigen grafiek.

NL

①



②

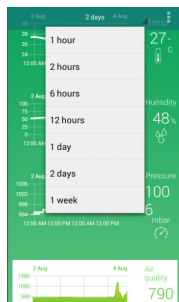

③

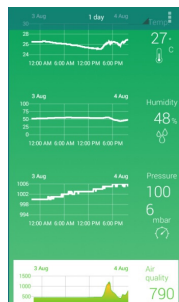



ARCHOS WEATHER STATION - Stations beheren

U kunt op ieder moment Weather Stations toevoegen en verwijderen.

Een Weather Station toevoegen

1. Open de Archos Weather Station app.
2. Tik op (pictogram met 3 punten) en kies **Station Manager**.
3. Kies Find stations [Stations zoeken].
4. U wordt doorverwezen naar de beginpagina van het ARCHOS Weather Station.
5. Kies Connect your Weather Station [Verbinding maken met Weather Station].
6. Kies het station dat u wilt toevoegen.
7. Tik op (pictogram met 3 punten) en schakel tussen uw stations door het gewenste station te kiezen.

NL

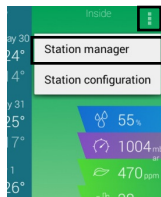

②

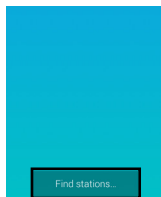

③

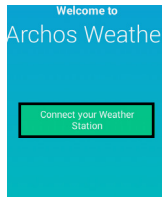

⑤

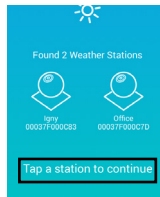

⑥

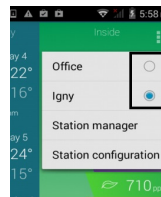

⑦





ARCHOS WEATHER STATION - Stations beheren

Een Weather Station uit de app verwijderen

1. Open de Archos Weather Station app.
2. Kies Station Manager in het parametermenu.
3. Druk lang op de naam van een station om deze te kiezen.
4. Kies Unregister [Verwijderen].

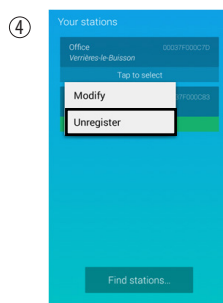
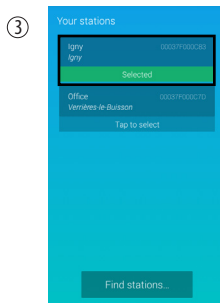
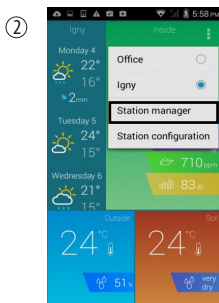

NL



ARCHOS WEATHER STATION - Stations beheren

Het Weather Station verbinden met een ander Wifi-netwerk

1. Open de Archos Weather Station app.
2. Beweeg uw hand over de binnenmodule om de groene lamp voor de luchtkwaliteit te controleren.
3. Houd uw hand tenminste 15 seconden boven de binnenmodule.
4. Het lampje van de binnenmodule knippert blauw en het station schakelt over naar de toegangspuntmodus.
5. Tik op (pictogram), kies Station Manager en dan Find stations [Stations zoeken].
6. Kies uw WiFi-netwerk en stuur het wachtwoord naar het Weather Station zodat het apparaat verbinding kan maken met het internet.
7. Terwijl uw Weather Station verbinding maakt, knippert het lampje van de binnenmodule rood.
8. Het is niet nodig om uw Weather Station opnieuw te registreren.

NL

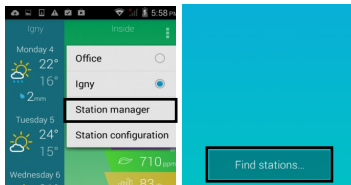

⑤

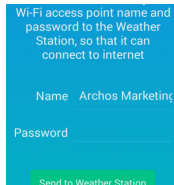

⑥

TIPS:

Als u deze modus onbedoeld activeert, kunt u gewoon wachten en geen bewerkingen uitvoeren op uw ARCHOS Weather Station. Na enkele minuten zal het station opnieuw verbinding maken.



ARCHOS WEATHER STATION - Modules beheren

Een ARCHOS Weather Station sensor toevoegen/verwijderen

1. Open de Archos Weather Station app.
2. Zorg ervoor dat de sensoren zich in de pairing-modus bevinden.
3. Tik op (pictogram) en kies Station Configuration [Stationconfiguratie] (afbeelding 1).
4. Kies Add or Remove a peripheral [Randapparatuur toevoegen of verwijderen] (afbeelding 2)

Een nieuwe sensor toevoegen

1. Kies Add a new sensor [Nieuwe sensor toevoegen] (afbeelding 3).
2. Als dit niet lukt, controleer dan of de batterijen goed zijn geplaatst en probeer het nogmaals.

Een sensor verwijderen

1. Druk op het pictogram van de sensor die u wilt verwijderen (afbeelding 4).
2. Klik op OK om uw sensor te verwijderen (afbeelding 5).



NL



Probleemoplossing

Waarom kan ik geen verbinding maken tussen mijn Weather Station en mijn mobiele apparaat?

Controleer of uw mobiele apparaat en uw Weather Station zijn verbonden met hetzelfde WiFi-netwerk.

Controleer of uw apparaat is gekoppeld (via pairing) met uw Weather Station.

Waarom reageren mijn sensoren niet? Geen gegevens of geen bijgewerkte gegevens. Zijn ze gekoppeld (via pairing) met uw Archos Weather Station? U kunt deze informatie controleren bij "Station Configuration"> "Peripherals" [Stationconfiguratie > Randapparatuur]. Controleer of Wifi is ingeschakeld op uw apparaat. Controleer of de batterijen van de buitenmodule en grondmodule niet leeg zijn. Vervang de batterijen als ze leeg zijn.

Controleer of uw sensoren zich niet te ver van de binnenmodule af bevinden.

Hoe kan ik de standaardinstellingen van mijn Weather Station herstellen?

Gebruik de Reset-knop onder het ARCHOS Weather Station.

Ga naar de instellingen van de ARCHOS Weather Station app: "Station manager"> "Select a station" > "Unregister" [Station manager > Station kiezen > Verwijderen].

NL



Índice

Conteúdo da Embalagem.....	82
Módulo Interior ARCHOS.....	83
Módulo Exterior ARCHOS.....	85
Módulo de Solo ARCHOS.....	86
Introdução.....	87
ARCHOS Weather Station - Primeira Configuração.....	88
ARCHOS Weather Station - Interface.....	90
ARCHOS Weather Station - Gestão de estações	91
ARCHOS Weather Station - Gerir módulos	95
Resolução de Problemas.....	96

Para mais informações, consulte as Perguntas Frequentes sobre o nosso produto em www.archos.com. Consulte-as antes de considerar devolver o produto. Poderão ocorrer algumas alterações nos procedimentos devido a atualizações de aplicações. Consulte a declaração de conformidade em http://www.archos.com/products/declaration_conformity.html





Conteúdo da Embalagem



Módulo Interior ARCHOS



Módulo Exterior ARCHOS



Módulo de Solo ARCHOS



PT



2 pilhas AA



2 pilhas CR2032



Adaptador AC



Manual QSG



Manual
de Garantia, Legal e Segurança





Módulo Interior ARCHOS

Descrição do Módulo Interior

1. Botão de reposição
2. Indicador de Emparelhamento e LED de qualidade do ar
3. Conetor de Alimentação



AÇÃO	ESTADO DO LED
Módulo em modo de emparelhamento e a aguardar ligação ao dispositivo	LED Azul intermitente
Telemóvel ligado ao módulo com sucesso	LED Azul sempre ligado

LED de indicador de estado sempre que desejar voltar a ligar o seu módulo interior ou durante a ligação.

AÇÃO	ESTADO DO LED
Módulo em modo de emparelhamento e a tentar ligar	LED Azul intermitente quase imediatamente após ligar
Módulo em tentativa de criar ligação ou ligação perdida	LED VERMELHO intermitente
Módulo ligado com sucesso	LED Verde durante 10s

PT



Módulo Interior ARCHOS

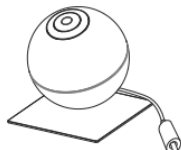

LED de indicador de estado

Passa a mão por cima do LED e verifique o nível de CO2 de acordo com a cor do LED para descobrir a qualidade do ar da sua casa.

COR	QUALIDADE DO AR
Verde	Boa Qualidade
Amarelo	A qualidade pode ser melhorada
Vermelho	O quarto deve ser ventilado



PT





Módulo Exterior ARCHOS

Descrição do Módulo Exterior

1. Indicador de Emparelhamento

O emparelhamento é feito ao inserir as pilhas. Se o emparelhamento não for conseguido, use o botão de reposição para ativar o modo de emparelhamento.

2. Base

3. Botão de reposição

4. Suporte das pilhas

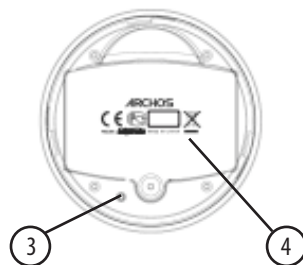
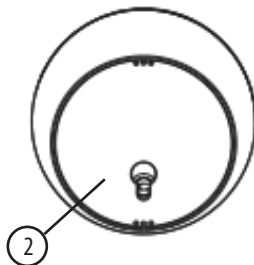
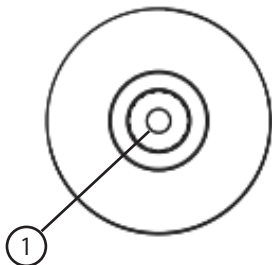

PT



Módulo de Solo ARCHOS

Descrição do Módulo de Solo

1. Botão de reposição
2. Sensor de Temperatura e Humidade
3. Compartimento das pilhas

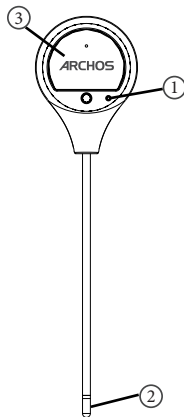

PT





Introdução

1. Ligue o cabo de alimentação ao conector de alimentação do Módulo Interior.



O seu dispositivo principal terá de ficar ligado a uma fonte de alimentação de forma permanente

2. Instale a Aplicação ARCHOS Weather Station a partir do Google Play ou Apple Store e siga todos os passos da configuração.

3. Coloque o Módulo Exterior em funcionamento.

1. Abra o Módulo Exterior
2. Abra o compartimento das Pilhas
3. Coloque duas pilhas AA
4. Feche o compartimento e o Módulo

4. Coloque o Módulo de Solo em funcionamento.

1. Abra o compartimento das Pilhas
2. Coloque 2 pilhas CR2032
3. Feche o compartimento

1.

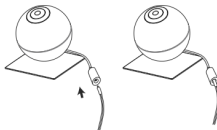

2.

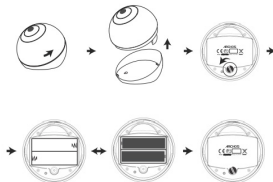

3.



PT 





ARCHOS WEATHER STATION - Primeira Configuração

Quando lançar a aplicação pela primeira vez, terá de ligar a sua estação de meteorologia.

1. Instale a Aplicação ARCHOS Weather Station através do Google Play ou Apple Store
2. Ligue a ligação WiFi no seu telemóvel ou tablet.
3. Inicie a Aplicação ARCHOS Weather Station
4. Procure estações de meteorologia Archos ao clicar em **Ligar** na sua **Estação de Meteorologia** e selecione a sua.

Uma nova estação de meteorologia deverá estar LIGADA para ser reconhecida pela aplicação. Uma vez selecionada, o LED deverá ficar azul intermitente. Se isto não acontecer passado alguns minutos, mantenha o dedo pressionado no botão na parte inferior da estação até que a luz fique azul intermitente.

5. Selecione a sua rede WiFi e envie a palavra-passe para a estação de meteorologia para que possa ligar à Internet.
6. Aguarde que a estação de meteorologia ligue à Internet.
7. Registe a sua estação de meteorologia e indique os seus dados: local, nome



PT





ARCHOS WEATHER STATION - Primeira Configuração

Quando a estação de meteorologia estiver ligada, adicione novos sensores.

Para emparelhar o Módulo Exterior

1. Certifique-se de que as duas pilhas AA estão bem colocadas no interior do compartimento.
2. Quando as pilhas estiverem colocadas no módulo, entrará em modo de emparelhamento.
3. Na aplicação, clique em "add a new sensor" (adicionar um novo sensor).
4. Emparelhamento concluído. Caso contrário, repita o processo e pressione o botão de reposição.

Para emparelhar o Módulo de Solo

1. Certifique-se de que as duas pilhas CR2032 estão bem colocadas no interior do compartimento.
2. Quando as pilhas estiverem colocadas no módulo, entrará em modo de emparelhamento.
3. Na aplicação, clique em "**add a new sensor**" (**adicionar um novo sensor**).
4. Emparelhamento concluído. Caso contrário, repita o processo e pressione o botão de reposição.

PT



ARCHOS WEATHER STATION - Interface

1. Previsão meteorológica para os próximos 6 dias

2. Sensores interiores

- A. Temperatura
- B. Humidade
- C. Pressão atmosférica
- D. Nível de CO₂
- E. Nível de ruído

3. Sensores exteriores

- A. Temperatura
- B. Humidade

4. Sensores do solo

- A. Temperatura
- B. Humidade

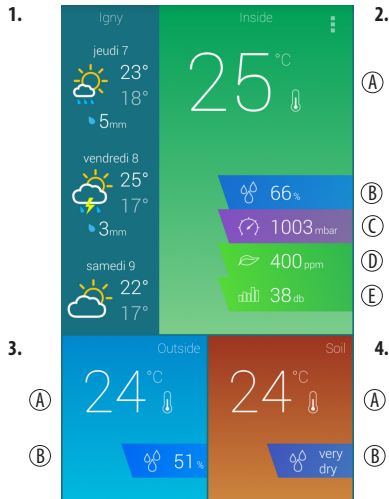

PT





ARCHOS WEATHER STATION - Gestão de estações

Quando estiver ligado à Aplicação Archos Weather Station, verifique os dados dos sensores de módulos em qualquer momento.

1. Selecione o sensor de módulo desejado e toque no seu ícone.
2. Selecione a escala (1h, 2h, 6h, 12h, 1 dia, 2 dias, 1 semana).
3. Siga a evolução ao longo do tempo e compare com dias/meses/anos anteriores através dos gráficos fornecidos com a aplicação. Cada sensor apresenta o seu próprio gráfico.

①



②

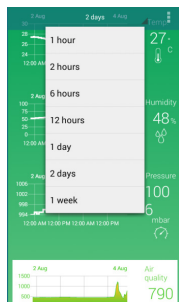

③

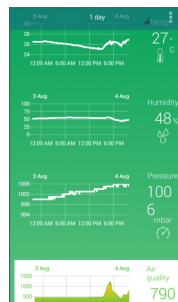



ARCHOS WEATHER STATION - Gestão de estações

Poderá adicionar ou remover estações de meteorologia a qualquer momento.

Para adicionar uma estação de meteorologia

1. Lance a Aplicação Archos Weather Station.
2. Toque em (ícone com 3 pontos) e selecione o **Station Manager (Gestor de Estações)**.
3. Selecione Find stations (Procurar estações).
4. Será redirecionado para a página principal da ARCHOS Weather Station.
5. Selecione Connect (Ligar) à Estação de Meteorologia
6. Selecione a estação que deseja adicionar.
7. Toque em (ícone com 3 pontos) e alterne entre as suas estações ao selecionar a estação desejada.



PT

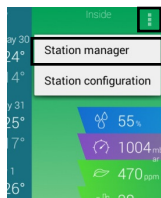

②

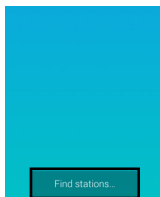

③

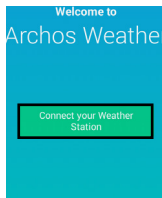

⑤

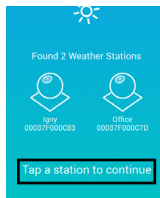

⑥

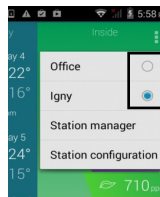

⑦





ARCHOS WEATHER STATION - Gestão de estações

Para remover uma Estação de Meteorologia da Aplicação

1. Lance a Aplicação Archos Weather Station.
2. Selecione o Station Manager (Gestor de Estações) no menu de parâmetros.
3. Mantenha o dedo pressionado no nome da estação para selecioná-la.
4. Selecione Unregister (Remover).

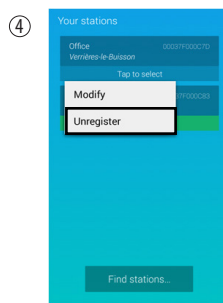
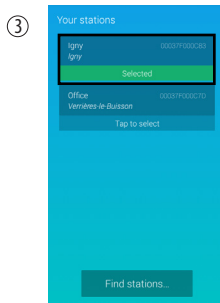
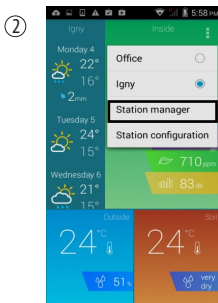



ARCHOS WEATHER STATION - Gestão de estações

Para ligar a sua estação de meteorologia a outra rede Wi-Fi

1. Lance a Aplicação Archos Weather Station.
2. Passe a mão por cima do Módulo Interior para ver o indicador de luz verde de qualidade de ar.
3. Mantenha a mão por cima do Módulo Interior durante pelo menos 15 segundos.
4. O Módulo Interior irá ficar azul intermitente e a estação entrará no modo de Ponto de Acesso.
5. Toque em (icon), selecione Gestor de Estações e depois selecione Procurar estações.
6. Selecione a sua rede WiFi e envie a palavra-passe para a estação de meteorologia para que possa ligar à Internet.
7. Enquanto a estação de meteorologia efetuar a ligação, o Módulo Interior ficará vermelho intermitente.
8. Não é necessário registar a sua estação de meteorologia de novo.



PT

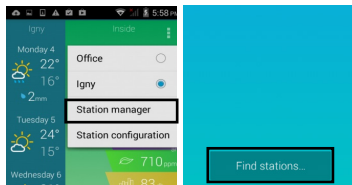

⑤

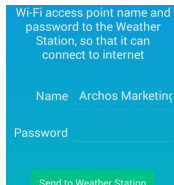

⑥

DICAS:

Se ativar este modo involuntariamente, poderá esperar sem tomar qualquer ação na ARCHOS Weather Station, e após alguns minutos, ligar-se-á de novo automaticamente





ARCHOS WEATHER STATION - Gerir módulos

Para adicionar/remover um sensor de ARCHOS Weather Station

1. Lance a aplicação ARCHOS Weather Station.
2. Certifique-se de que os sensores estão no modo de emparelhamento
3. Toque em (ícone) e selecione Station Configuration (Configuração de Estação) (figura 1)
4. Selecione Add or Remove a peripheral (Adicionar ou Remover um periférico) (figura 2)

Para adicionar um novo sensor

1. Selecione Add a new sensor (Adicionar um novo sensor) (figura 3)
2. Se nenhum sensor tiver sido adicionado, verifique se as pilhas estão bem inseridas e tente novamente

Para remover um sensor

1. Pressione o ícone do sensor que deseja remover (figura 4)
Clique em OK para remover o sensor (figura 5)





Resolução de problemas

Porque é que não consigo ligar a minha estação de meteorologia ao meu dispositivo móvel?

Verifique se o seu dispositivo móvel e a sua estação de meteorologia estão ambos ligados à mesma rede WiFi.

Verifique se o seu dispositivo está emparelhado com a estação de meteorologia

Porque que é que os meus sensores não respondem? Sem dados ou dados não atualizados. Estão corretamente emparelhados com a sua estação de meteorologia Archos?

Pode verificar esta informação em "Station Configuration" < "Peripherals" ("Configuração da Estação" < "Periféricos"). Verifique se a rede WiFi está LIGADA no seu dispositivo. Verifique se as pilhas estão a funcionar no módulo Exterior e no sensor de solo. Se não funcionarem, terá de colocar novas pilhas.

Verifique se os seus sensores estão suficientemente próximos do seu Módulo Interior.

Como posso repor as definições predefinidas da minha estação de meteorologia?

Pressione o botão de reposição na parte inferior da estação de meteorologia.

Aceda às definições da aplicação ARCHOS Weather Station: "Station manager" < "Select a station" < "Unregister" ("Gestão de estações" < "Selecione uma estação" < "Remover")



PT





Оглавление

Комплектация.....	98
Модуль ARCHOS для использования внутри помещения.....	99
Модуль ARCHOS для использования вне помещения.....	101
Модуль ARCHOS для контроля состояния почвы.....	102
Начало работы.....	103
Метеостанция ARCHOS - начальная настройка.....	104
Метеостанция ARCHOS - интерфейс.....	106
Метеостанция ARCHOS - управление станциями.....	107
Метеостанция ARCHOS - Управление модулями.....	111
Устранение неисправностей.....	112

Для получения дополнительных сведений посетите раздел часто задаваемых вопросов (FAQs) на сайте www.archos.com. Обязательно ознакомьтесь с представленными рекомендациями до принятия решения о возврате товара.

В связи с обновлением приложений указанные процедуры могут быть изменены.

Обратитесь к декларации о соответствии на http://www.archos.com/products/declaration_conformity.html

RU



Комплектация



Модуль ARCHOS
для использования
внутри помещения



Модуль ARCHOS для
использования вне
помещений



Модуль ARCHOS
для контроля
состояния почвы



Батарейки AA - 2 шт.



Батарейки CR2032 - 2 шт.



Адаптер переменного тока



Краткое руководство
пользователя



Информация о юридических
гарантиях и
и инструкции по безопасности

RU



Модуль ARCHOS для использования внутри помещения

Описание модуля

1. Кнопка перезапуска
2. Индикатор подключения и светодиодный индикатор качества воздуха
3. Разъем питания



ДЕЙСТВИЕ	СОСТОЯНИЕ ИНДИКАТОРА
Модуль находится в режиме установления соединения и ожидает подключения к устройству	Светодиодный индикатор мигает синим светом
Мобильное устройство подключено успешно	Синий светодиодный индикатор постоянно включен

Светодиоды загораются каждый раз, когда вы пытаетесь переподключить модуль, или если устройство используется.

ДЕЙСТВИЕ	СОСТОЯНИЕ ИНДИКАТОРА
Модуль находится в режиме установления соединения и пытается подключиться к устройству.	Синий светодиодный индикатор начинает мигать почти сразу же после включения питания
Модуль пытается подключиться, либо подключение не активно	Светодиодный индикатор мигает красным светом
Подключение модуля выполнено успешно	Зеленый светодиодный индикатор горит в течение 10 сек.

RU



Модуль ARCHOS для использования внутри помещения

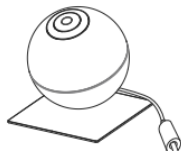

Светодиодный индикатор состояния воздуха

Для определения качества воздуха в вашем доме проведите рукой над светодиодным индикатором и проверьте уровень CO₂ в соответствии с цветом светодиода.

ЦВЕТ	КАЧЕСТВО ВОЗДУХА
Зеленый	Хорошее качество
Желтый	Качество можно улучшить
Красный	Следует проветрить комнату



RU



Модуль ARCHOS для использования вне помещения

Описание модуля для использования вне помещений

1. Индикатор установления соединения

Режим подключения активируется сразу же после помещения в устройство батареек. Если операция не успешна, для активации режима подключения используйте кнопку перезапуска.

2. База

3. Кнопка перезапуска

4. Держатель батареек

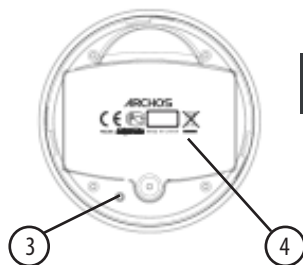
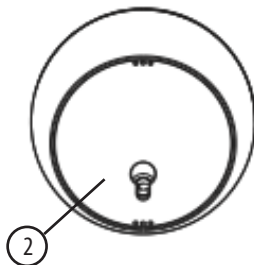
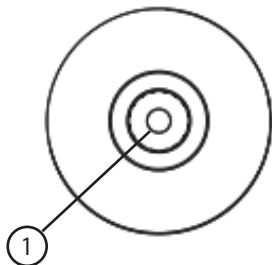

RU



Модуль ARCHOS для контроля состояния почвы

Описание модуля для контроля состояния почвы

1. Кнопка перезапуска
2. Усовершенствованный датчик температуры и влажности
3. Батарейный отсек

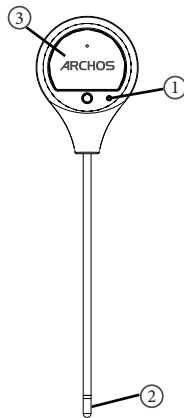

RU





Начало работы

1. Подключите кабель к разъёму питания модуля для использования внутри помещений. 1.



Основное устройство должно быть всегда подключено к источнику питания.

2. Загрузите приложение ARCHOS Weather Station в Google Play Store или Apple Store, а затем следуйте указаниям по настройке.

3. Активируйте рабочий режим модуля для использования вне помещений.

1. Открутите винты модуля для использования вне помещений.

2. Открутите винты батарейного отсека.

3. Поместите в отсек две батарейки AA.

4. Снова закрепите крышку батарейного отсека и закройте корпус модуля.

4. Активируйте рабочий режим датчика контроля состояния почвы.

1. Открутите винты батарейного отсека.

2. Поместите в отсек две батарейки CR2032

3. Снова закрепите крышку батарейного отсека.

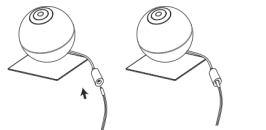

2.

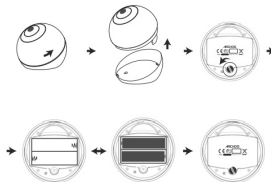

3.



RU



МЕТЕОСТАНЦИЯ ARCHOS - начальная настройка

При первом запуске приложения вам потребуется установить подключение к метеостанции.

1. Загрузите приложение ARCHOS Weather Station в Google Play Store или Apple Store
2. Активируйте подключение к WiFi-сетям на смартфоне или планшете.
3. Запустите приложение ARCHOS Weather Station
4. Выполните поиск метеостанций Archos, нажав «Connect your **Weather Station**», а затем выберите вашу станцию.

Чтобы приложение обнаружило новую метеостанцию, она должна быть включена, а после ее выбора светодиодный индикатор должен загореться синим цветом. Если это не случилось по истечении нескольких минут, нажмите и удерживайте кнопку внизу станции до тех пор, пока индикатор не замигает синим светом.

5. Выберите свою сеть WiFi и отправьте пароль метеостанции, чтобы она смогла подключиться к Интернету.
6. Дождитесь установления соединения с метеостанцией.
7. Зарегистрируйте метеостанцию и задайте свои данные: местонахождение, имя.

RU



МЕТЕОСТАНЦИЯ ARCHOS - начальная настройка

После подключения метеостанции добавьте новые датчики.

Подключение модуля для использования вне помещений

1. Убедитесь, что две батарейки AA размещены в своих гнездах должным образом.
2. Сразу после установки батареек в модуль устройство переходит в режим подключения.
3. В приложении нажмите «add a new sensor» (добавить новый датчик).
4. Соединение установлено. В противном случае повторите весь процесс и нажмите кнопку перезапуска.

Подключение модуля контроля состояния почвы

1. Убедитесь, что две батарейки CR2032 размещены в своих гнездах должным образом.
2. Сразу после установки батареек в модуль устройство переходит в режим подключения.
3. В приложении нажмите «**add a new sensor**» (добавить новый датчик).
4. Соединение установлено. В противном случае повторите весь процесс и нажмите кнопку перезапуска.

RU



Метеостанция ARCHOS -интерфейс

1. Прогноз погоды на ближайшие 6 дней

2. Датчики для размещения внутри помещений

- A. Температура
- B. Влажность
- C. Атмосферное давление
- D. Уровень CO2
- E. Уровень шума

3. Датчики для размещения вне помещений

- A. Температура
- B. Влажность

4. Датчики контроля состояния почвы

- A. Температура
- B. Влажность

1.



2.

(A)

(B)

(C)

(D)

(E)

3.

(A)

(B)

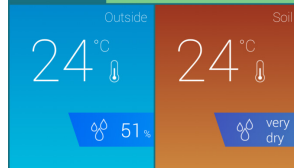

4.

(A)

(B)

RU



МЕТЕОСТАНЦИЯ ARCHOS - управление станциями

Подключившись к приложению Archos Weather Station, вы в любой момент сможете проверить показания датчиков своих модулей.

1. Выберите требуемый датчик модуля и коснитесь его значка.
2. Выберите шкалу (1 ч, 2 ч, 6 ч, 12 ч, 1 день, 2 дня, 1 неделя).
3. Следите за развитием ситуации во времени и сравните показания с аналогичными данными за предыдущие дни/месяцы/годы, просмотрев графики, созданные в приложении. По каждому датчику создаются специальные графики.

①



②

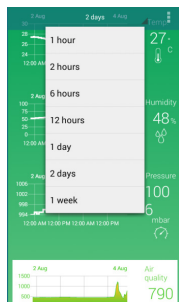

③

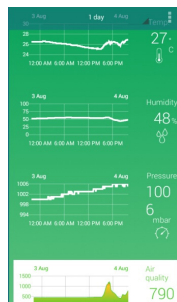

RU







МЕТЕОСТАНЦИЯ ARCHOS - управление станциями

Вы можете добавлять или удалять метеостанции в любой момент.

Добавление метеостанции

1. Запустите приложение Archos Weather Station.
2. Коснитесь значка  и выберите «**Station Manager**».
3. Выберите «Find stations» (найти станции).
4. Вы перенаправлены на домашнюю страницу ARCHOS Weather Station.
5. Выберите «Connect your Weather Station» (подключить метеостанцию).
6. Выберите станцию, которую желаете добавить.
7. Коснитесь значка  и переключайтесь между своими станциями, выбирая необходимую.

RU

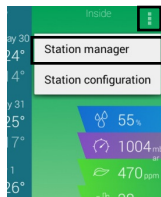

②

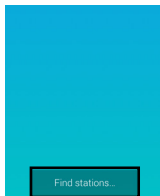

③

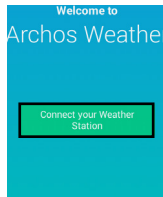

⑤

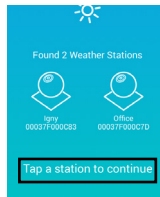

⑥

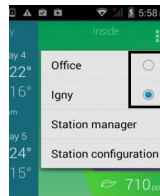

⑦





МЕТЕОСТАНЦИЯ ARCHOS - управление станциями

Удаление метеостанции из приложения

1. Запустите приложение Archos Weather Station.
2. Выберите «Station Manager» в меню параметров.
3. Выберите станцию длительным нажатием.
4. Выберите «Unregister» (отменить регистрацию).

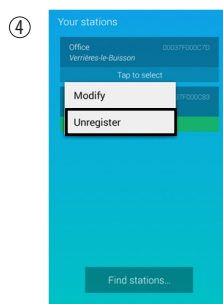
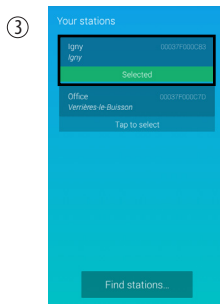
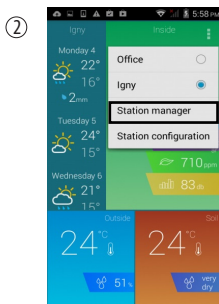

RU



МЕТЕОСТАНЦИЯ ARCHOS - управление станциями

Подключение метеостанции к другой сети Wifi

1. Запустите приложение ARCHOS Weather Station.
2. Проведите рукой над модулем, предназначенным для использования внутри помещений, чтобы загорелся зеленый свет, свидетельствующий о качестве воздуха.
3. Удерживайте руку над указанным модулем не менее 15 секунд.
4. Светодиодный индикатор модуля замигает синим светом, а станция переключится в режим «Access Point» (точка доступа).
5. Коснитесь (значок), выберите «Station Manager», а затем «Find stations» (найти станции).
6. Выберите свою сеть Wifi и отправьте пароль метеостанции, чтобы она смогла подключиться к Интернету.
7. В ходе подключения метеостанции светодиодный индикатор модуля замигает красным светом.
8. Нет необходимости повторно регистрировать свою метеостанцию.

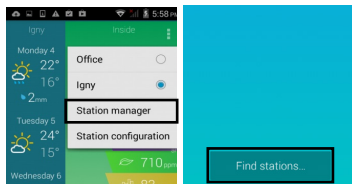

5

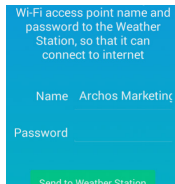

6

СОВЕТЫ:

Если данный режим активирован ненамеренно, можете подождать, не предпринимая каких-либо действий со своей метеостанцией ARCHOS, а по истечении нескольких минут произойдет автоматическое переключение.

RU



МЕТЕОСТАНЦИЯ ARCHOS- управление модулями

Добавление/удаление датчика метеостанции ARCHOS

1. Запустите приложение ARCHOS Weather.
2. Убедитесь, что датчики находятся в режиме подключения.
3. Коснитесь (значок) и выберите «Station Configuration» (конфигурация станции) (Рис.1).
4. Выберите «Add or Remove a peripheral» (добавить или удалить периферийное устройство) (Рис.2).

Добавление нового датчика

1. Выберите «Add a new sensor» (добавить новый датчик) (Рис.3)
2. Операция выполнена. Если операция не успешна, проверьте, правильно ли вставлены батарейки, и повторите попытку.

Удаление датчика

1. Нажмите значок датчика, который вы желаете удалить (Рис. 4)
2. Нажмите «ОК» для удаления датчика (Рис.5)



RU



Устранение неисправностей

Почему я не могу подключиться к метеостанции с помощью мобильного устройства?

Проверьте, подключены ли мобильное устройство и метеостанция к одной и той же сети WiFi.

Проверьте, подключено ли устройство к метеостанции.

Почему мои датчики не дают реакцию? Получено сообщение об отсутствии данных или обновлений. Они правильно подключены к метеостанции Archos? Можете это проверить в разделе «Station Configuration» < «Peripherals» «Check if Wifi is ON in your device». Проверьте наличие батареек в модуле для использования вне помещений и датчике состояния почвы. В этом случае потребуется заменить их.

Проверьте, достаточно ли близко расположены датчики к модулю для использования внутри помещений.

RU

Как восстановить настройки метеостанции по умолчанию?

Используйте кнопку перезапуска под метеостанцией ARCHOS.

Перейдите в раздел настроек приложения ARCHOS Weather: «Station manager» < «Select a station» (выбрать станцию) < «Unregister» (отменить регистрацию)



Table des matières

Contenu de la boîte.....	114
ARCHOS Indoor Module.....	115
ARCHOS Outdoor Module.....	117
ARCHOS Soil Module.....	118
Mise en route.....	119
ARCHOS Weather Station- Premier Pas.....	120
ARCHOS WEATHER STATION - Interface.....	122
ARCHOS Weather Station- Gestion des stations.....	123
ARCHOS Weather Station- Gestion des accessoires.....	127
Dépannage.....	128

Pour plus d'information, consultez de ce produit sur www.archos.com. Consultez-les avant d'envisager un éventuel retour du produit. Les procédures peuvent connaître certains changements dus à des mises à jour de l'application. Consultez la déclaration de conformité sur http://www.archos.com/products/declaration_conformity.html

FR



Contenu de la boîte



ARCHOS Indoor Module



ARCHOS Outdoor Module



ARCHOS Soil Module



2 x AA piles



2x CR2032 piles



FR



Adaptateur



Guide d'utilisation
rapide



Guide des garanties et
des mentions légales





ARCHOS Indoor Module

Description de l'Indoor Module

1. Bouton de réinitialisation
2. Témoin de fonctionnement
LED indicateur de la qualité de l'air
3. Connecteur d'alimentation

Il contient le capteur de température et doit par conséquent être maintenu éloigné de toute source de chaleur.

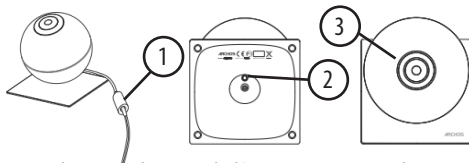

La première fois que vous allumez votre application ARCHOS Weather Station, l'assistant de démarrage vous permet de paramétrer votre application et vous devrez connecter votre Weather Station à internet en renseignant les informations de votre connexion Wifi.

ACTION	Statuts de la LED
Lorsque le module est en mode association et en attente de se connecter à l'appareil (tablette,...)	La LED clignote en bleu
Lorsque le module est connecté avec succès à l'appareil	La LED reste allumée avec une couleur bleue

Etat de la LED à chaque fois que vous désirez reconnecter votre indoor module ou lors de son utilisation.

ACTION	Statuts de la LED
Lorsque le module est en mode association et en attente de se connecter	La LED bleue clignote dès que l'appareil est allumé
Lorsque le module tente de se connecter ou perd la connexion	La LED clignote en rouge
Lorsque le module se connecte avec succès	La LED reste allumée en vert pendant 10 secondes

FR





ARCHOS Indoor Module

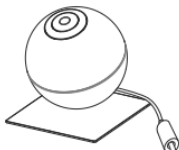

Etat de la LED

Passez votre main au dessus de l'indicateur lumineux pour voir la qualité de l'air selon la couleur de la LED.

COULEUR	QUALITE DE L'AIR
Verte	Bonne qualité
Jaune	La qualité peut être améliorée
Rouge	La pièce doit être aérée



FR





ARCHOS Outdoor Module

Description de l'Outdoor Module

1. Témoin de fonctionnement

En insérant les piles, le module passe en mode association. En cas d'échec de l'association, ce mode s'active en utilisant le bouton de réinitialisation.

2. Support

3. Bouton de réinitialisation

4. Compartiment des piles

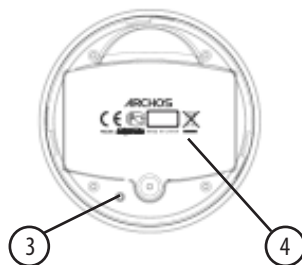
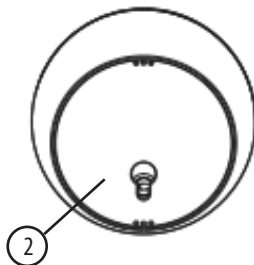
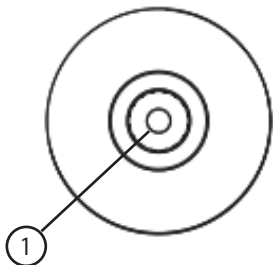

FR



ARCHOS Soil Module

Description du Soil Module

1. Bouton de réinitialisation
2. Capteur de température et d'humidité
3. Compartement des piles

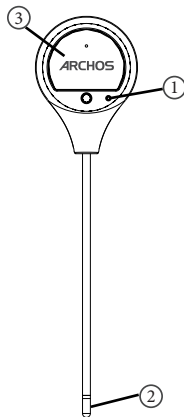

FR



Mise en route

1. Connectez le chargeur dans le connecteur d'alimentation de l'Indoor module.



Votre module principal doit être connecté en permanence à l'alimentation électrique.

2. Téléchargez l'application ARCHOS Weather Station depuis Google Play Store ou Apple Store et suivez les instructions de configuration.

3. Mise en service de la Weather Station.

1. Ouvrir l'Outdoor module en séparant le haut du bas.
2. Dévissez le compartiment des piles.
3. Placez les deux piles AA.
4. Revissez le compartiment et refermez le module.

4. Mise en service du Soil Sensor

1. Dévissez le compartiment des piles.
2. Placez deux piles CR2032.
3. Revissez le compartiment.

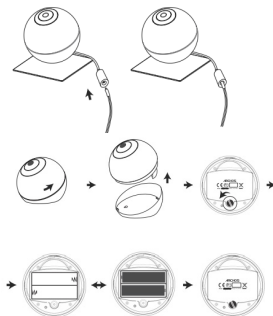

3.



FR



ARCHOS WEATHER STATION - Premiers pas

La première fois que vous lancerez votre application ARCHOS Weather Station, vous devrez connecter votre Weather Station.

1. Téléchargez l'application ARCHOS Weather Station depuis Google Play Store ou Apple Store .
2. Activez la WiFi sur votre smartphone ou tablette.
3. Lancez l'application ARCHOS Weather Station.
4. Recherchez des ARCHOS Weather Stations en cliquant sur Connecter votre Weather Station, puis sélectionnez la votre. Une nouvelle Weather Station doit être branchée pour être reconnue par l'application et la LED doit s'allumer en bleue une fois sélectionnée. Si ce n'est pas le cas après plusieurs minutes, appuyez longtemps sur le bouton situé sous le module principal jusqu'à qu'il clignote en bleu.
5. Sélectionnez votre réseau WiFi et tapez votre mot de passe pour que votre Station se connecte à internet. Attendez que votre Weather Station se connecte.
6. Enregistrez votre Weather Station et renseignez ses informations: localisation, nom

FR

A new Weather Station must be powered ON to be recognized by the application and once selected, the LED must blink in blue. If it is not the case after a few minutes, perform a long press on the button below the station until the light blinks in blue.



ARCHOS WEATHER STATION - Premiers pas

Une fois que votre Weather Station est connectée, ajoutez de nouveaux modules.

Pour associer l'Outdoor module

1. Vérifiez que les deux piles AA sont bien placées dans leur compartiment.
 2. Dès que les piles sont en place, le module passe en mode association.
 3. Cliquez su «Ajouter un nouveau capteur» sur votre application.
- Si l'association échoue, essayez de nouveau cette procédure en appuyant sur le bouton de réinitialisation.

Pour associer le Soil Module

1. Vérifiez que les deux piles CR2032 sont bien placées dans leur compartiment.
2. As soon as the batteries are in the module, it is in pairing mode.
3. Dés que les piles sont en place, le module passe en mode association.
4. Si l'association échoue, essayez de nouveau cette procédure en appuyant sur le bouton de réinitialisation.

FR



ARCHOS WEATHER STATION - Interface

1. Prévisions Météo pour les 6 prochains jours

2. Capteurs intérieurs

- A. Temperature
- B. Humidité
- C. Pression atmosphérique
- D. Niveau de CO2
- E. Nuisance sonore

3. Capteurs extérieurs

- A. Temperature
- B. Humidité

4. Capteurs du sol

- 1. Temperature
- 2. Humidité

1.



2.

(A)

(B)

(C)

(D)

(E)

3.



4.

(A)

(B)

(A)

(B)

FR



ARCHOS WEATHER STATION - Gestion des stations

Lorsque vous êtes connecté sur votre application ARCHOS Weather Station, lisez les informations des capteurs à tout moment.

1. Sélectionnez le capteur qui vous intéresse et cliquez sur son icône.
2. Sélectionnez une échelle (1h, 2h, 6h, 12h, 1 jour, 2 jours, 1 semaine).
3. Suivez l'évolution au fil du temps et comparez les valeurs aux jours / mois / années précédentes à travers tous les graphiques fournis par l'application. Chaque capteur possède ses propres graphiques.

①



②

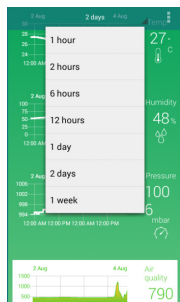

③

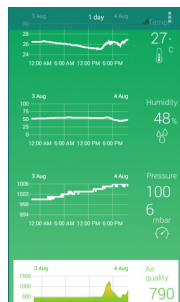

FR





ARCHOS WEATHER STATION - Gestion des stations

Vous pouvez ajouter ou retirer des Weather Stations à tout moment.

Pour ajouter une Weather Station

1. Lancer l'application ARCHOS Weather Station.
2. Cliquez sur (icone avec les 3 points) et sélectionnez Gérer les stations.
3. Sélectionnez Rechercher des stations.

Vous êtes redirigé vers la page d'accueil d'ARCHOS Weather Station.

4. Sélectionnez Connecter votre Weather Station
5. Sélectionnez la station que vous désirez ajouter.
6. Cliquez sur (icon 3 points) et passez d'une station à l'autre en sélectionnant celle de votre choix.

FR

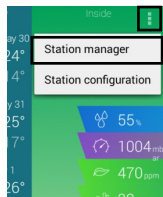

②

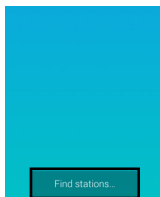

③

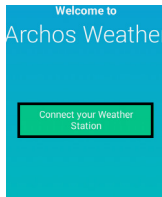

⑤

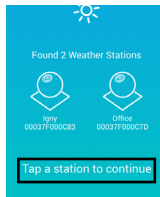

⑥

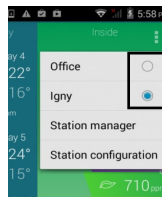

⑦





ARCHOS WEATHER STATION - Gestion des stations

Pour retirer une Weather Station de votre application

1. Lancer l'application ARCHOS Weather Station.
2. Cliquez sur (icone avec les 3 points) et sélectionnez Gérer les stations.
3. Sélectionnez une station en appuyant longtemps sur son nom.
4. Sélectionnez Dissocier.

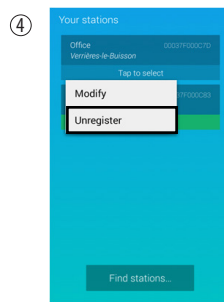
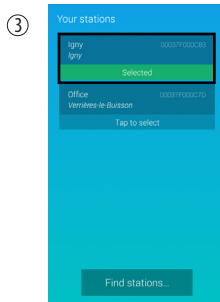
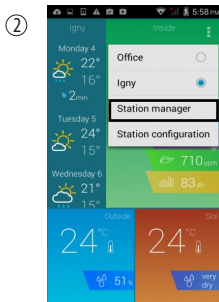

FR



ARCHOS WEATHER STATION - Gestion des stations

Pour connecter votre Weather Station à un autre réseau WiFi

1. Lancer l'application ARCHOS Weather Station
 2. Passez votre main au-dessus de l'Indoor Module pour voir apparaître la lumière verte de la LED qui indique la qualité de l'air.
 3. Gardez votre main au-dessus de l'Indoor Module pendant au moins 15 secondes. L'Indoor Module clignote en bleu et la station passe en mode Access Point.
 4. Cliquez sur (icone avec les 3 points) et sélectionnez Gérer les stations puis Trouver des stations.
 5. Sélectionnez votre réseau WiFi et tapez votre mot de passe pour que votre Station se connecte à internet.
 6. Pendant que votre Weather Station se connecte, l'Indoor Module clignote en rouge.
- Il n'est pas nécessaire de réenregistrer votre Weather Station.

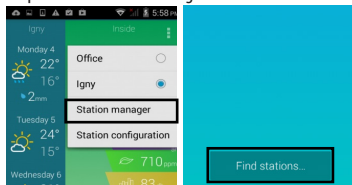

⑤

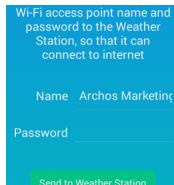

⑥

ASTUCES:

Si vous déclenchez ce mode accidentellement, vous pouvez attendre sans faire la moindre action sur votre ARCHOS Weather Station et après quelques minutes, elle se reconnectera automatiquement

FR



ARCHOS WEATHER STATION - Gestion des accessoires

Pour rajouter/retirer un capteur à l'ARCHOS Weather Station

1. Lancer l'application ARCHOS Weather Station.
2. Assurez-vous que les capteurs sont en mode association.
3. Cliquez sur l'icône de menu en haut et sélectionnez Configurer la Station.
4. Sélectionnez Ajouter ou Retirer un capteur.

Pour ajouter un nouveau capteur

1. Sélectionnez Ajouter un nouveau capteur.
2. Si l'association n'a pas lieu, vérifiez que les piles sont bien insérées

Pour retirer un capteur

1. Cliquez sur l'icône du capteur que vous désirez retirer.
2. Cliquez sur OK pour retirer le capteur.

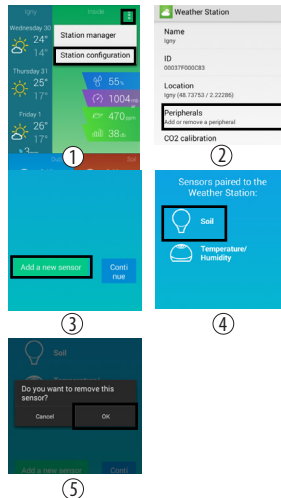

FR



Dépannage

Que puis-je faire en cas de dysfonctionnement du WiFi?

Vérifiez que votre appareil mobile et votre Weather Station sont bien connectés au même réseau WiFi. Vérifiez que votre appareil est connecté à votre Weather Station.

Pourquoi les capteurs n'interagissent plus avec l'application Weather Station?

Sont-ils correctement associés à votre ARCHOS Weather Station? Vous pouvez vérifier cette information dans 'Configurer la Station' < 'Capteurs. Vérifiez que votre WiFi est activée sur votre appareil. Vérifiez que les piles de l'Outdoor Module et du Soill Module ne sont pas épuisées. Si oui, remplacez-les.

Vérifiez que vos capteurs sont assez proches de votre Indoor Module.

FR

Comment restaurer my Weather Station à ses paramètres d'usine?

Utilisez le bouton RESET situé en bas de la Weather station.

Sur l'application ARCHOS Weather, allez sur Paramètres > Gestionnaire de stations > Sélectionnez une station > Supprimer.





National restrictions

This device is intended for home and office use in all EU countries (and other countries following the EU directive 1999/5/EC) without any limitation except for the countries mentioned below:

Country Restriction Reason/remark

Bulgaria None General authorization required for outdoor use and public service

France Outdoor use limited to 10 mW e.i.r.p. within the band 2454-2483.5 MHz

Military Radiolocation use. Refarming of the 2.4 GHz band has been ongoing in recent years to allow current relaxed regulation.

Full implementation planned 2012

Italy None If used outside of own premises, general authorization is required.

Luxembourg None General authorization required for network and service supply (not for spectrum)

Norway Implemented This subsection does not apply for the geographical area within a radius of 20 km from the centre of Ny-Alesund

Russian Federation None Only for indoor applications

Note: Frequency 2454-2483.5MHz are restricted to indoor use in France.

Consult the declaration of conformity on http://www.archos.com/products/declaration_conformity.html





Open Source Software Offer

The software bundled with this product includes software files subject to certain open source license requirements. Such open source software files are subject solely to the terms of the relevant open source software license. Such open source software is provided on an "AS IS" basis to the maximum extent permitted by applicable law.

For the open source files contained herein, please access "Open source license" section located at: Settings>About tablet\Legal information on the device for the relevant copyright and licensing terms. You may obtain a copy of Apache License, Version 2.0 at <http://www.apache.org/licenses/LICENSE-2.0>. You may also obtain a copy of GNU General Public License, Version 2 at the Free Software Foundation, INC, 51 Franklin Street, Fifth Floor, Boston, MA 02110-1301, USA.

Until the date that is three years after our last shipment of this product, you may obtain a copy of the source code corresponding to the binaries for any GPL-Licensed file by contacting ARCHOS customer service at <http://www.archos.com> and ARCHOS will send you a link to such source code or will provide instructions to get the source on a physical medium.

This offer is valid to anyone in receipt of this information.

Archos company declares that this device is in compliance with the essential requirements and other relevant provisions of Directive 1999/5/EC.

This device complies with part 15 of the FCC Rules. Operation is subject to the following two conditions: (1) This device may not cause harmful interference, and (2) this device must accept any interference received, including interference that may cause undesired operation.

